

COMMUNITY STATE BANK

CAPITAL AND SURPLUS \$50,000.00

YOUR BANK

W. S. SYMONDS, President
G. E. BULLINGTON, Vice-Pres.

WALTER W. VAN NOY, Cashier
J. C. WALLACE, Asst. Cashier

Telephone Directory



BRISTOW, OKLA.

WINTER, 1925

QUAKER DRUG CO.

CALL ANY DOCTOR WE WILL FILL HIS PRESCRIPTION

PHYSICIANS AND SURGEONS

	Office	Res.
7 Dr. E. W. Reynolds	48	198
Dr. W. G. Bisbee	632	489
Dr. E. W. King	104	815-W
Dr. J. Clay Williams	525	28
2 Dr. A. E. Martin	830	830
Dr. J. M. Wells	80	267
Dr. O. C. Coppedge	78	68
5 Dr. C. M. Gillespie	525	406
Drs. Sisler & Sisler	900	915

TEL.
740
&
725

DENTISTS

	Office	Res.
Dr. A. T. Watson	42	527 7
Dr. R. E. Smoot	500	882-W
Dr. R. L. Ralls	611	357-W 4
Dr. G. R. Hansen	704	583-W
Dr. F. A. Gray	525	816-W
Dr. R. W. Conger	172	356 0.

YES WE DELIVER

BUSY BEE CAFE

Bristow's Favorite Coffee

We Are Noted For Our Excellent
And Tasty Food.

**HAVE YOU TRIED A CUP OF
OUR SPLENDID COFFEE?**

MAKE THE BUSY BEE YOUR CAFE

TEL. 732

TEL. 732

IDEAL CLEANERS & TAILORS

ONE DAY SERVICE

**IF WE GET EM BEFORE 11 OCLOCK
WE GET EM BACK BEFORE
7 P. M.**

112 E 6 ST.

PHONE 733

Southwestern Bell Telephone Company

BRISTOW, OKLA., WINTER, 1925

C. B. Billingsley, Dist. Mgr.

Sapulpa, Oklahoma

IMPORTANT INFORMATION

To Report a Telephone Out of Order.....	Call "Repair Clerk"
To Make a Long Distance Call.....	"Long Distance"
To Call a Rural Subscriber Call.....	"Rural Operator"
For Telephone Numbers Which Do Not Appear in Directory.....	Call "Information"
To Obtain Assistance or to Report Unsatisfactory Service on Local Calls Call.....	"Chief Operator"
To Obtain Assistance or to Report Unsatisfactory Service on Long Distance Calls, Call.....	"Long Distance Chief Operator."
To Obtain Information Relative to Contracts, Bills, Moving Telephone, Etc. Call.....	170

EMERGENCY CALLS

To Report a Fire Call.....	"Fire Department"
To Call Police, Call.....	252

HOW TO MAKE A TELEPHONE CALL

OBTAIN THE CORRECT NUMBER FROM THE TELEPHONE DIRECTORY. Remove the receiver from the hook and place it to your ear. When the operator answers, "Number Please," give the number found in the directory distinctly one figure at a time, as for example: "THREE - OH - ONE - THREE - W" for 3013-W. When the figure O appears in a number, it should be pronounced as "OH." With the receiver to your ear, listen for the ringing signal, the busy signal, or a report from the operator.

TO RECALL THE OPERATOR at any time during a connection, move the hook up and down slowly five or six times, and repeat until the operator answers. A rapid movement of the hook gives the operator no signal whatever. Do not hang up the receiver until you are through with the connection, as this gives the operator a signal to disconnect you.

LONG DISTANCE SERVICE

The Southwestern Bell Telephone Company through its relation with other telephone companies, is enabled to establish communication promptly at reasonable cost to almost any telephone in the United States, as well as to telephones in many cities in Canada and Cuba.

Long Distance rates and charges are based upon: (1) Mileage distance between telephones connected; and (2) The length of time the connection is held by the patron.

The different classifications of long distance service are as follows:

STATION-TO-STATION

A "Station-to-Station" call is one placed for anyone who answers a specific telephone at another place. This is the simplest sort of long distance call and consequently can be completed with the greatest speed and at the lowest cost.

This class of service can be used in all cases where it is satisfactory to establish connection when anyone answers at the called telephone. Calls for "one of the firm" or "anyone who can talk business" or for a certain department or for a specified station of a private branch exchange system are "person-to-person" calls.

Charges on Station-to-Station calls cannot be reversed; i.e., Charged to the called telephone.

STATION-TO-STATION "DAY" RATES apply on calls when the conversation begins between 4:30 A. M. and 8:30 P. M.

STATION-TO-STATION "EVENING" RATES apply on calls when conversation begins between 8:30 P. M. and midnight, and are about one-half of the day rate where the day rate is 50c or over and 25c where the day rate is between 25c and 50c. Calls between points where the day rate is 25c or less receive no reduced rate.

STATION-TO-STATION "NIGHT" RATES apply on calls when conversation begins between midnight and 4:30 A. M., and are about one-fourth of the day rate where the day rate is \$1.00 or more and 25c where the day rate is between 25c and \$1.00. Calls between points where the day rate is 25c or less receive no reduced rate.

When a call is completed between points where different times of day apply, the time of day at the calling point governs.

Report charges (explained later) do not apply on Station-to-Station calls.

TO PLACE A STATION-TO-STATION CALL where the number of the telephone desired is known, give the long distance operator information as follows: "This is a Station-to-Station call-4-3552, John Smith, calling Chicago, Illinois. I wish to speak to anyone at Lincoln 1000." If the number of the desired telephone is not known, give the long distance operator information as follows: "This is a Station-to-Station call-4-3552, John Smith, calling Chicago, Illinois. I wish to speak to anyone in John Brown's office in the Wrigley Building."

PERSON-TO-PERSON CALLS

A "Person-to-Person" call is one on which a particular person, or someone of a group of persons, or a certain station of a private branch exchange system, is specified to be reached at the called telephone. The rates on "person-to-person" calls are approximately 25% higher than the rates on Station-to-Station calls, and reduced EVENING and NIGHT rates do not apply.

The charges on Person-to-Person calls may be reversed and billed to the called telephone, if the operator is so instructed when the call is placed, and if the called person accepts the charge.

TO PLACE A PERSON-TO-PERSON CALL, give the long distance operator information as follows: "This is 4-3552, John Smith, calling Chicago, Illinois. I wish to speak to John Brown at the Chicago Hotel."

APPOINTMENT CALLS

An "Appointment" call is a type of Person-to-Person call on which conversation is to be established at a specified time.

The rates for Appointment calls are approximately 20% higher than for ordinary Person-to-Person calls. Reduced EVENING and NIGHT rates do not apply.

MESSAGE CALLS

A "Messenger" call is a type of Person-to-Person call on which the called person cannot be reached by telephone and it is necessary for the telephone company to arrange for a messenger to notify the called person to come to a telephone.

Rates for messenger service must be added. Reduced EVENING and NIGHT rates do not apply.

No "Messenger" call will be accepted unless the person calling guarantees payment for the messenger service. If a messenger charge is incurred, the charge will be made even if the desired conversation is not held.

REPORT CHARGE

(Applies to Inter-State Calls Only)

It is sometimes impossible to establish conversation on Person-to-Person, Appointment and Messenger calls, due to reasons beyond the control of the telephone company and although the preliminary work of handling the call is properly performed. In such cases a small charge is made for the work already done. Conditions under which a report charge is made include:

(1) Refusal of the called person to talk or allow the charges to be reversed.

(2) Inability to reach the called or calling person after the called point has been reached, or an appointment arranged for; and

(3) Inability on the part of the telephone company to locate the called person when insufficient information has been supplied by the person placing the call.

If, at the request of the calling party, attempts are made to reach the called party at more than one city or town, the attempt made at each city called will be considered a separate call, and the report charge applied accordingly. The charge is not made unless a definite report is made within one hour after the call is placed, provided that no delay is announced at the time the call is accepted. No charge is made when the reason for not completing the call is because "lines are busy," "out of order" or because the "called telephone does not answer."

Report charges do not apply to Station-to-Station calls.

REQUESTS FOR CHARGES

If a patron desires notification of the amount of the charge on a message, the long distance operator should be so advised at the time the call is placed. If the request for such information is not made until the completion of the conversation, unavoidable delay results while the operator obtains the rate and computes the charge.

RATES

The following table shows an example of the difference in rates for the various classes of long distance service. Unless otherwise indicated, these rates are for a three minute conversation. Additional minutes are charged for proportionately.

MISCELLANEOUS INFORMATION

EMERGENCY CALLS. Report to the Fire Department and Police when the patrons do not call by number, are not a part of the service for which the telephone company contracts, but are purely and accommodation and may be discontinued at any time. The telephone company assumes no liability whatever for damages in rendering this accommodation service, and the patron by requesting such service makes the operator his agent for such purpose.

ERRORS IN DIRECTORY. Great care is exercised in the preparation of this directory, but the Southwestern Bell Telephone Company assumes no liability whatever for damages arising from errors and omissions in the printing of this directory.

CHANGE OF TELEPHONE NUMBERS.

The telephone company reserves the right to change telephone numbers from time to time as the necessities of the business may require, and, therefore, subscribers are urged not to use their telephone numbers in advertising matter. The phrase "Bell Telephone Connection" is suggested instead.

MOVING TELEPHONES. As a large amount of telephone equipment has to be moved yearly, it is necessary that subscribers give at least ten days' notice in writing when they are moving to new quarters. Ample notice will enable us to move telephone equipment so that telephone service will be practically uninterrupted. Owing to the large number of move orders on or about May 1st and October 1st, thirty days' notice should be given of moves desired at those times, if possible.

ANY CHANGE IN THE LOCATION OF TELEPHONE INSTRUMENTS and equipment must be made by the employees of the telephone company.

WHEN ANSWERING CALLS time will be saved if you immediately give your number or name, as "6342," "4-9013W" or "Jones' Department Store." This informs the person calling that the desired connection is established. Please answer the telephone promptly—Courtesy to the calling party requires it.

UNSATISFACTORY SERVICE. Uniform courtesy and politeness is an imperative rule of this Company, and all employees are required to be courteous and patient at all times. If service is unsatisfactory, prompt report should be made of it by calling "Chief Operator." Do not report unsatisfactory service to the operators, as conversation by operators, beyond that necessary to complete connections, impairs the service. Report of unsatisfactory service should be telephoned, not written, as more satisfactory investigation is possible when an immediate report is made to the Chief Operator.

This directory is the property of the Southwestern Bell Telephone Company. It is loaned free of cost to the subscribers and must be returned upon the delivery of a copy of the new edition.

FROM BRISTOW, OKLAHOMA

TO:	STATION-TO-STATION RATE			CORRESPONDING RATE		
	Day 4:30 A. M. to 8:30 P. M.	Evening 8:30 P. M. to Midnight	Night Midnight to 4:30 A. M.	Person to Person Call	App'tment and Messenger* Call	Rept Chg for Per.-to-Per, Appointment Mssgr* Call
Kansas City -----	1 60	80	40	2 00	2 40	40
Dallas - -----	1 40	70	35	1 75	2 10	35
Enid -----	65	35	25	80	95	—
Ardmore -----	—	45	25	1 05	1 25	—

*Plus Messenger Fee. Rates to any point will be furnished immediately on request. Call "Long Distance" and ask for the Rate Clerk.

EXCHANGE RATES PER ANNUM within the Corporate Limits and mile radius of the Office:
BUSINESS—Special Line \$36.00, Extension Telephone \$12.00, Name Service \$6.00.
RESIDENCE—Special Line \$21, 2-Party Line \$18, Exten. Tele. \$9, Name Service \$3.
MOVING TELEPHONES—From one house to another when equipment is in place \$.50.
 When not in place \$2.00. Changing location of telephone on same premises \$1.00.

Ford

\$155.00 DOWN

BALANCE EASY TERMS

BRISTOW MOTOR CO. Call 275
L. M. LIST, Mgr.

ALPHABETICAL LIST

BRISTOW, OKLAHOMA

R. J. BENZEL, General Manager

GENERAL OFFICES, Oklahoma City

A & A Dry Goods Co, 6th and Main.....	61	ANDERSON & GILLILAND , 7th & Main.....	813
ABRAHAM, ED , Store, 114 N Main.....	65	ANDERSON & GILLILAND , Drug Store, 7th and Main.....	855
Abraham, Ed, res, 5th and Maple.....	69-J	Anderson, Jack, res, 409 E 6th.....	156-W
Abraham, Ed, res, 202 W 5th.....	69-W	Anderson, L R, res, 320 W 6th.....	205
Abraham, Ellis, res, E 7th.....	897-W	ANNETTE GIFT SHOP , Roland Hotel Bldg.....	278
Abraham, Joe, Office, 6th and Main.....	355	Arlington Rooms, Main and 8th.....	512
Abraham, Joe, res, West 8th.....	20	Armour, W L., res, 12th & Elm.....	451
Abraham, Louis, res, 320 W 11th.....	718-W	Army Store, 121 South Main.....	881
Abraham, Sam, res, 223 W 9th.....	472-W	Arthurs, C W, res, 9th and Elm.....	579-J
Abraham, Useph, Store, South Main.....	87	Ash, Okey A, res, 315½ E 8th.....	763-J
Abraham, Useph, res, 229 W 10th.....	618-W	Ash, Ray, res, 210 E 7th.....	588-J
Adamie, J G, res, 247 W 9th.....	472-J	Ashmore, Emmett, rural, NW of City.....	9519-F13
Adams, B L, res, 112 W 5th.....	286-W	Ashmore, J A, rural, NW of City.....	9519-F5
Adams, E D, res, 402 E 9th.....	313-W		

FISK TIRES

PHIL-MONT SERVICE CO.

SECOND AND MAIN TELEPHONE 852
TIRE AND TUBE SERVICE

Addle, J M, Office, 1st State Bank Bldg.....	186	Atlantic Oil Prop Co, Gas Bldg.....	462
ADVANCE BEAUTY SHOP 217 Groom Bldg.....	780	Austin, W H, res, 412 W 12th.....	666-J
ALAMO GARAGE , rural.....	9522-F3	Avery, Mr, rural, N of City.....	9534-F14
Alba, H C, res, West 11th.....	437-W		
ALEXANDER HOTEL , 121½ S Main.....	843		
Alleman, L E, res, 411 W 5th.....	571-J		
Allen, Tom, rural, NW of City.....	9529-F21		
Alsop, Rev James, res, 110 N Elm.....	329		
Alton, J R, res, 520 E 3rd.....	469-W		
Alvis, Roy, Feed Store, 126 E 3rd.....	963		
Amer Drug Co, 113 S Main.....	261		
AMERICAN HOTEL , 112½ E 7th.....	1022		
AMERICAN NATL BANK , 7th and Main.....	1		
American Ry Express Co, Frisco Depot.....	1011		
AMER TOOL & SUP CO 118 W 1st.....	560		
Amer Tool & Supply Co, 116 W 1st.....	460		
Ames, Harry O, res, 137½ W 7th.....	924-J		
Amity Gasoline Co, rural.....	9512-F12		
Anderson, Addie, res, 523 E 10th.....	385-W		
Anderson, C R, res, Windsor Court Apts.....	853-J		

B

B & M Filling Station, 3rd and Main.....	100-J
Babione, W E, res, 113 S Cherry.....	481-W
BADGER ICE CO , South Main.....	100-W
Baker, J H, rural, S of City.....	9533-F3
Baker, Joe, rural.....	9530-F3
Baker, J T, rural, S of City.....	9521-F2
Baker, R B, res, 414 W 12th.....	861-W
Baker, W O., res, Chestnut & 4th.....	243
Banister, G E, res, 237 W 6th.....	177-W
Banks, W R, res, 417 E 8th.....	376
Banks, W W, res, 320 E 6th.....	419
Baptist Church, First, 226 E 6th.....	598-J
Barker, H H, res, 247 W 6th.....	422

PARISIAN CLEANERS

107 E. Seventh

"SUDDEN SERVICE"

Phone 131

BRISTOW STEAM LAUNDRY

Phone 337

We use soft Water

Phone 337

Barker, Joe K, res, 405 W 7th.....	628-W	Bingham, W R, res, 329 W 11th.....	450
Barker, R C, res, 419 W 9th.....	3	BISBEE, DR W G , Office, 206 Groom Bl.....	632
Barnerd, M M, res, 310 E 5th.....	25	Bisbee, Dr W G, res, 10th & Maple.....	489
Barnes, Ed, res, 207 W 2nd.....	509	Bishop & Bishop Grocery, Chestnut & 1st.....	609-W
Barnes, Joel, res, 501 E 1st.....	350-W	Bishop, F E, res, W 8th.....	246-W
Barnett, Mrs Pearl, res, 11th and Main.....	383	BISHOP & ROACH MOTOR CO 207 E 7th.....	122
Barney, A H, res, 314 W 11th.....	114-W	BLACK, SIVALLS & BRYSON , (L L Brooks, Mgr, 245 W 8th.....	222
Barr, Geo, res, 136 W 11th.....	231	BLACK, SIVALLS & BRYSON Yard, 141 E 10th.....	241
BATES (TOM) BATTERY CO , 214 South Main.....	778	Blakey, R C, res, 214 W 9th.....	581-J
BATES, TOM , res, 421 W 9th.....	594-J	Blaylock, H J, Newstand, 105 W 6th.....	766
Bath, Chas, rural, NW of City.....	9519-F2	Blosch, H H, rural, S of City.....	9521-F22
Batts, James, res, 404 N Chestnut.....	12-J	Blosch, L F, rural, S of City.....	9521-F12
Bauter, J W, res, 132 E 11th.....	668-W	Blosch, Ed, res, 229 E 5th.....	274
Beal, Harold C, res, 812 S Chesnut.....	824-J	BLUE RIBBON BAKERY , 112 S Main.....	129
BEARMAN, A S , Office Supply, Rear of Buchan's Jewellery.....	974	Bogle, James, res, 411 E 7th.....	266-W
Bearman, A S, res, 214 W 7th.....	230-W	BOGLE, J M , General Store, N Main.....	2
Beaver, Chas O, res, 133 W 11th.....	314	Bond, H A, res, 720 East 4th.....	828-J
Beck, T E, res, 414 E 3rd.....	179	Booth, R O, res, 216 W 11th.....	815-J

UNDERTAKING

Stubblefield & Sullivan
AMBULANCE
Day & Night **PHONE 847**
Residence **PHONE 544-J**

Beckner, T L, res, 316 W 7th.....	81-W	Borthick, J W, res, 717 S Oak.....	919-J
Benedum, C H, res, 207 W 7th.....	792	Boss, E W, res, 311 E 4th.....	480
Benedum, C H, 120 S Main.....	336	Boston Store, 213 N Main.....	93
Bennett, Mrs Bertha, res, 402 N Maple.....	990-W	Bottger, Howard, res, 409 W 2nd.....	1013-J
Bennett, W H, res, 3rd & Chestnut.....	212-W	Boucher, Cleve, rural, N of City.....	9508-F12
Benton Hotel, 217½ S Main.....	1028	Bovaird Supply Co, South Main.....	779
BERGMAN, DAVE , res, 106 S Main.....	461	Bowers, A L, res, 413 E 8th.....	774-J
Berry, Frank, res, 421 W 2nd.....	753-J	BOWMAN, L E , General Store, 113 W 5th.....	40
Berry, T A, res, 116 W 1st.....	460	Bowman, Lee, res, LaVinna Apts.....	882-W
BESHARA, SAID , Groc and Confecti, 111½ S Main.....	675	Boyd, C F, res, 511 E 5th.....	421-W
Beshara, Sam, res, 319 W 9th.....	633-W	Boyd's Furniture Store, 520 N Main.....	389
Bethel, L M, rural, N of City.....	9534-F3	Boyd, H M, rural.....	9510-F11
Beucher, C H, rural, N of City.....	9534-F111	Boyd, Miss U, res, 246 W 7th.....	379-W
Bible, Willie, res, 303 E 12th.....	392-W	Bracken, D R, res, 219 E 2nd.....	605-W
Bieber, G F, res, 219 S Maple.....	239-J	Bradford Rig & Reel, West 1st.....	1006
Billington, Mrs Ruth, res, 207 E 2nd.....	97-W	Brazil, W, res, 510 E Lincoln.....	665-W
Bill's Fur Exchange, 135 E 5th.....	466	Brewer, Mrs R L, res, 121 W 4th.....	973-W
BILLS GARAGE , 118 S Walnut.....	280	BREWSTER, J R , Atty, 4 Bogle Bl.....	608
Bingaman, Lon, res, 217 E 4th.....	21-J	Brewster, J R, res, 213 E 7th.....	821-W
		Brisco, T J, res, 215 S Oak.....	211-W

SUNBEAM **G** **GROCERY & TEL. 885**
SANITARY **G** **MARKET TEL. 681**
HOME OF RICHELIEU AND SUNBEAM PURE FOOD PRODUCTS

Ford

\$155.00 DOWN

BALANCE EASY TERMS

BRISTOW MOTOR CO. Call 275

L. M. LIST, Mgr.

Bristow Auto Salvage Co, 107 E 2nd..... 793

BRISTOW BATTERY STATION

122 East 6th..... 443

BRISTOW BLDG & LOAN ASSN

114 West 6th..... 126

Bristow, City of:—

City Clerk..... 54

City Water Works..... 393

Chief of Police..... 252

Mayor's Office City Hall..... 976

Bristow City Park..... 985

Bristow Club, 123 S Main..... 46

Bristow Cotton Oil Co, South Main..... 801

Bristow Country Club, rural, W of City..... 9543-F2

Bristow Dairy Co, 143 W 10th..... 748

Bristow Drug Co, 219 N Main..... 91

Bristow Emergency Hospital, 11th & Maple..... 878

Bristow Feed Co, West 8th..... 624

Bristow Floral Co, 122 W 5th..... 143

BRISTOW GASOLINE & SUPPLY CO.

10th and Main..... 92

Bristow Presbyterian Church, 6th & Elm..... 526-W

Bristow Produce Co, 131 East 5th..... 728

Bristow RI Est & Investment Co, E 8th..... 140

BRISTOW RECORD, Printing, 112 W 6th..... 52

Bristow Tin Shop, 109 E 5th..... 224

BRISTOW TIRE SHOP, 215 S Main..... 187

Bristow Transfer & Storage Co, 118 E 7th..... 120

Bristow Variety Store, South Main..... 45

Britten, Carlos E, res, 608½ S Main..... 411-J

Britton, S P, res, 137 W 10th..... 424

Britton, S P, rural, NW of City..... 9519-F4

Brock, J L, res, 419 W 9th..... 758-J

Bronaugh, J A, Truck Contr 300 E 3rd..... 747

Brooks Grocery, 126 East 6th..... 397

Broome, R F, res, 116 N Chestnut..... 886-W

Brown, Clara Ethel, res, 306 W 6th..... 332-W

Brown, J B, res, 508 N Main..... 804-W

Brown, Q L, res, 728 S Hickory..... 877-W

Brown, S P, res, 223 W 6th..... 498

Brown, Wm C, res, 502 W 7th..... 340

HIGH GRADE PETROLEUM PRODUCTS

ACCESSORIES

PHIL-MONT SERVICE CO.

WHOLESALE AND RETAIL

SECOND AND MAIN

TELEPHONE 852

BRISTOW GASOLINE & SUPPLY CO.

10th and Main..... 942

BRISTOW GASOLINE & SUPPLY CO.

Freeland Station..... 795

BRISTOW GASOLINE & SUPPLY CO.

Storage Garage..... 64

Bristow Gasoline & Supply Co, Warehouse,

North of City..... 652-W

Bristow General Hospital, N Main..... 352

Bristow Gas Corporation, 123 W 7th..... 301

BRISTOW HOTEL 7th and Main..... 50

Bristow Ice Cream & Bottling Co 118 W 6th..... 160

BRISTOW JEWELRY CO. 207 N Main..... 914

BRISTOW LAUNDRY W 6th..... 337

Bristow Motor Co, 10th and Main..... 276

Private Branch Exchange

Bristow Motor Co, 9th & Main..... 521

BRISTOW PACKING HOUSE MARKET,

213 South Walnut..... 602

Bristow Pipe & Mach Co, W 1st..... 467

Bristow Plumbing Co, 218 E 7th..... 486

Browning, Roy, res, 617 W 8th..... 981-W

Bruce, J W, rural, NE of City..... 9537-F6

Bruffett, C O, res, 110 S Pecan..... 961-J

Brunswick Billiard Parlor, 102 S Main..... 983

Bryson, S B, res, 244 W 9th..... 363-W

BUCHAN, FRANK G, Jewelry, Main..... 151

Buchan, Frank C, res, West 11th..... 607-W

Budlong, A B, res, 302 E 9th..... 145-J

Burch, G E, res, 412 E 8th..... 773-J

Burke, Alice, res, 6 Krumrei Apts..... 149-J

Burke, Greis Oil Co, 243 W 8th..... 664

Burke, J S, res, 416 E 9th..... 372-W

Burks, R C, res, 1 Krumrei Apts..... 149-W

Burleson, J W, res, 817 S Poplar..... 776-J

Burnett, Mrs Sue, res, 236 W 9th..... 418-W

Burt, Millard, res, 510 W 9th..... 926-J

Burt, Mrs M N, res, 324 W 8th..... 139-J

Burton R O, res, S Chestnut..... 968-W

BUSY BEE CAFE, East 7th..... 732

Butterfield, Roy, res, 903 S Main..... 167-J

PARISIAN CLEANERS

107 E. Seventh

"SUDDEN SERVICE"

Phone 131

BRISTOW STEAM LAUNDRY

Phone 337

THRIFT-SERVICE

Phone 337

Bu-Vi-Bar Petroleum Corp, W 7th..... 302
Bu-Vi-Bar Petro Corp, Chubby Farm..... 9531-F2
Byers, W L, res, 139 W 5th..... 526-J

C

G & C TRUCK CO, 911 S Main..... 642-J
Cacy, L B, res, Windsor Court Apts..... 809-J
Call, Alice, res, 210 N Elm..... 917-W
Callaway, W Z, res, 218 E 7th..... 691-J
Campbell, B R, res, 233 W 11th..... 487-W
Campbell, Chas, res, 320 E 11th..... 894-W
Campbell, Tom, res, 315 E 8th..... 686-J
Canady, G W, res, 308 E 4th..... 552-J
Canterbury, R H, res, 310 W 8th..... 67-W
CANTERBURY, S L, Ins, Amer Natl Bk Bldg 534
Canterbury, S L, res, 308 W 11th..... 114-J
Cantrell, T H, res, 1st and Oak..... 968-J
Capps, Oscar, rural, S of City..... 9507-F5

Cheatham & Beaver, Attys, 1st State Bk Bldg..... 55
Cheatham, W L, res, 228 W 11th..... 15
Christian, L G, rural, S of City..... 9515-F13
City Meat Market, 116 S Main..... 370
City Officers—(See Bristow, City of:—)
City Studio, 215½ N Main..... 739
Clark, Arthur L, res, 313 N Hickory..... 562-W
CLARKE BROTHERS, South Main..... 66
Clark, Harry, res, West 5th..... 263-W
Clarke, Mrs A L, Sr, res, 242 W 6th..... 175
Clarke, Al, Jr, res, Windsor Court Apts..... 649-W
Clarke, Wm L, res, Windsor Court Apts..... 809-W
Cleveland, J L, res, 602 E 5th..... 898-J
Clinton, W, res, 406 E 4th..... 155-J
Coburn, A B, res, 605 W 8th..... 546-W
Coca Cola Bottling Co, 219 E 7th..... 826
C O D Feed Co, 420 S Main..... 715
Coffman, Ray, res, 225 W 4th..... 499-J
COLAW, A L, Plumber, North Main..... 74
Colaw, A L, res, 112 E 10th..... 220

UNDERTAKING

Stubblefield & Sullivan
AMBULANCE
Day & Night PHONE 847
Residence PHONE 544-J

Carman, Geo S, res, 300 W 6th..... 321-W
Carman, H W, res, 619 N Main..... 56
Carpenter, L P, res, 322 N Maple..... 936-J
Carr, H S, res, 248 W 4th..... 293
Carter Oil Co, rural, N of City..... 9532-F5
Carter Oil Co, NW of City..... 9500-F2
Carter Oil Co, N of City..... 9532-F2
Carter Oil Co (Green Lease) NW of City..... 9500-F3
Casey, L B, res, 2 Windsor Court Apts..... 809-J
Castator, Jack, rural, S of City..... 9521-F15
CENTRAL GARAGE, 115 W 7th..... 64
CENTRAL MEAT MARKET, N Main..... 35
Chamber of Commerce, Roland Hotel Bldg..... 672
Chapman, Art, res, East 9th..... 396
Chapman Grocery, 401 W 12th..... 690
Chapman's (Neal C) Grocery & Market,
Oak Street..... 707
Chapman, Neal C, res, 219 E 4th..... 116-J
Chapman, Stanford, res, 606 S Chesnut..... 191-J
Chappell, M D, res, 311 W 7th..... 435-J

Cole, Charles W, res, 206 E 3rd..... 889-J
Cole, M L, res, 214 E 8th..... 695-J
Collier, Mary F, res, 402 E 3rd..... 285
Collins, Raymond, res, 409½ W 9th..... 1017-J
Combs, A J, res, 302 W 7th..... 180-W
COMBS ALBA Agency, 204 Groom Bldg..... 270
Combs, Guy, res, 127 W 7th..... 569
Combs, Joe A, res, 142 W 8th..... 128
Combs, L W, res, S Hickory..... 736-J
COMMERCIAL PRINTING CO,
120 East 7th..... 616
COMMUNITY STATE BANK, 6th & Main..... 388
Conger, L B, res, 720 S Chestnut..... 483-J
Conger, Dr R W, Dentist, 103 S Main..... 172
Conger, Dr R W, res, 514 E 6th..... 356
Conrad, C R, res, 501 E 5th..... 447-W
CONSTANTINE OIL CORP 5th & Main..... 353
CONTINENTAL SUPPLY CO Store
120 S Main..... 761
Continental Supply Co, Mgr Ofc, 120 S Main..... 336

SUNBEAM GROCERY & TEL. 885
SANITARY G MARKET TEL. 681
HOME OF RICHELIEU AND SUNBEAM PURE FOOD PRODUCTS

Ford

\$155.00 DOWN

BALANCE EASY TERMS

BRISTOW MOTOR CO. Call 275
L. M. LIST, Mgr.

Continental Supply Co, Wrhse, 2nd & Wal. 514
Conver, B H, res, 216 E 5th. 856-W
Conway Boiler Welding Co, 139 W 1st. 746
Conway, Jas, res, 212 E Washington. 684-J
COOKS ROOMING HOUSE, 120 E 6th. 176
Cooper, Dr C E, res, 509 N Chestnut. 12-W
Copenhagen, H L, res, Windsor Court Apt. 806-J
Coppedge, B T, res, 231 E 7th. 507
Coppedge, Dr O C, Office, Over Abraham's 78
Coppedge, Dr O C, res, 503 E 7th. 68
Corey, A G, res, 318 W 7th. 113
Corey, F S, res, 324 W 10th. 791-J
Corey, H W, res, 114 N Chestnut. 43
Corey & Joseph Store, 320 N Main. 775
Cornellson, Pearl, res, 309 E 2nd. 97-J
Cortez Oil Co, rural, NW of City. 9518-F2
Cortez Oil Co, rural, NW of City. 9529-F3
Coryell, L S, res, 337 W 5th. 332-J
Couch, Henry C, res, 214 East 6th. 524-W
Coulter, I W, res, 420 E 9th. 764-W

Curran, B F, res, 131 W 5th. 964-W
Curtess, R L, res, 208 East 2nd. 256-W
Curtis, Ed, res, 126 N Elm. 230-J
Cushing Tim, Tool & Supply Co, 205 E 8th. 410
Cushing, Tim, res, 211 E 8th. 199-J
Cushman, R J, res, 221 W 5th. 325-J
Cusom Gln, East 9th. 787

D

Dailey, W B, res, 410 E 3rd. 229-J
Damar Producing Co, Amer Natl Bk Bl. 19
Darnell, J B, res, 317 S Oak. 206
Darnell, W C, res, 515 E Jefferson. 694-J
Daugherty, Sam, rural. 9507-F12
Davidson, Harry, res, 202 W 9th. 89-W
Davis, C P, Business, Roland Hotel Bl. 960
Davis, C P, res, 616 W 6th. 959-W
Davis, Carter T, Roland Hotel Bl. 960

FISK TIRES

PHIL-MONT SERVICE CO.

SECOND AND MAIN TELEPHONE 882
TIRE AND TUBE SERVICE

Covey, C D, res, 401 W 2nd. 930-W
COX, C B, Buick Dealer, Main and 4th. 452
Cox, Liza, res, 113 W 1st. 441-J
Craig, J W, res, 17 Windsor Court Apts. 470-J
Craker, Paul, res, 111 E 12th. 136
Crawford, W E, res, 706 S Walnut. 408-W
Creek, County of:—
County Attorneys Office, City Hall. 786
Sheriff's Office, City Hall. 975
Superior Court Clerk, City Hall. 476
Crislip, C, res, 117 S Cherry. 317-W
Crites, Simon, res, 503 S Main. 71-W
CRUTCHFIELDS, A Man's Shop,
305 N Main. 580
Crutchfield, J W, res, 518 W 6th. 110-J
Cundy, B C, 213 W 7th. 112
Cunningham, Homer, res, 608 S Main. 71-J
Curl, L L, res, 404 E 4th. 574-W
Curran, C Lee, 213 Groom Bl. 923
Curran, C Lee, res, Windsor Court Apts. 390-W

Davis, Carter T, res, 517 W 7th. 532-W
Davis, Foster, res, 409 W 11th. 636-W
Davis, Marvin M, res, 202 E Lincoln. 643-J
DAVIS (W H) ELECTRIC CO. 720
Davison, A H, res, 326 W 11th. 477-W
Day, I E, res, E Lincoln. 520-W
Dean, C W, res, 324 W 8th. 937-W
Deaver, Ira C, res, 126 W 8th. 872-W
Deck Clamp Tank Co, 220 E 8th. 723
DeFrance, H L, rural, NW of City. 9529-F111
Delano, J M, rural. 9515-F4
DELANO MOTOR CO, 117 E 9th. 225
Delano, M V, res, 237 W 9th. 111-J
Delano Radio & Elec Co, 407 N Main. 935
Delano, S M, res, W 6th. 964-J
Depreitere, Rev E, res, 209 W 8th. 89-J
Dettweiler, W J, res, 226 W 7th. 716-W
Dial, C E, res, 206 E 7th. 197-J
Dickinson, May, res, 140 W 2nd. 660-W
Dilley, H A, res, 312 E 4th. 548-J

PARISIAN CLEANERS

107 E. Seventh

"SUDDEN SERVICE"

Phone 131

BRISTOW STEAM LAUNDRY

Phone 337

WET WASH

Phone 337

Dixie Barber Shop, 130 S Main.....	713	Elias, K, res, 238 W 10th.....	273-W
Dixie Store, 118 S Main.....	677	Elias, Swap, res, 134 W 9th.....	561
Dole, J W, res, 614 East 6th.....	833-W	Ellis, W R, res, 501 E Jefferson.....	694-W
Don Hotel, 112 E 4th.....	965	Endsley, Lee, res, 504 E 8th.....	696-J
Dorris, Andrew B, res, 409 W 8th.....	928-W	ETHERICAL STUDIO , Roland Hotel Bl.....	334
Douglas, R K, res, 816 S Walnut.....	181-J	Evans, O M, res, 513 E 5th.....	421-J
Dove, J H, res, 923 S Chestnut.....	659-J	Evans, Roy, res, 209 S Elm.....	810-J
Dowdy, Will, rural, S of City.....	9533-F22	EVERGREEN FARMS , W of City.....	683
Dowler, Earl, res, 204 S Elm.....	789-W	Evers, John, rural.....	9534-F25
Dressler, C A, rural, NW of City.....	9519-F12	Ewing, F X, res, 307 E 6th.....	413-J
Dubbs, F A, res, 144 W 5th.....	810-W	Exelton, Eugene, res, 112 E 11th.....	185
Duffy, J F, res, 300 E 10th.....	228	EXIDE BATTERY STATION , 214 S Main.....	778
Dumas, G E, res, 246 W 11th.....	22-W	Exleton, Mrs Amelia, res, 110 E 11th.....	105-W
Dumas, J H A, rural, NW of City.....	9528-F2		
Dumas, M E, res, 1st and Chestnut.....	168-W		
Dunaway, M A, res, 2nd & Oak.....	41		
Duncan, R E, res, 308 E 4th.....	211-J		
Dunham, W H, res, 143½ W 10th.....	203-W		
Dunlapp, Mrs N E, res, 121 E 6th.....	1008-J		
Dunn, R W, res, 112 N Elm.....	133-J		

F

F & E Truck Co, 1st and Main.....	795
Faith, J P, res, 4th and Hickory.....	663-J

UNDERTAKING

Stubblefield & Sullivan
AMBULANCE
Day & Night PHONE 847
Residence PHONE 544-J

Dupree, H L, rural, W of City.....	9500-F11	FAMILY WET WASH LAUNDRY , Walnut and Lincoln.....	744
Duquene Petroleum Co, NW of City.....	9528-F13	Famous Department Store, 112 S Main.....	138
Durham, Earl, res, 235 W 4th.....	475	Farmer, B A, res, 339 W 5th.....	943-J
Durham, H L, res, East 9th.....	562-J	Farmers Custom Gin, 3rd Street.....	831
Dwyer, S E, Rig Contr, 409 E 3rd.....	361	FARMERS GROCERY , North Main.....	5
Dyer, A D, res, 600 S Main.....	676-W	Farnham, H P, res, 405 W 2nd.....	930-J
		Ferguson, J E, res, 500 E Lincoln.....	665-J
		Fesler, R H, res, 720 E 5th.....	729-J
		Fessler, H B, res, 141 W 10th.....	241
		Fielder, Mrs A, res, 114 N Elm.....	34
		Fire Station, 104 E 8th.....	88
		FIRST NATIONAL BANK , 7th and Main.....	8
		Fisk, J O, Taxi Co, 110 E 6th.....	500
		Fisk, J O, res, 724 E 4th.....	842-W
		Fitch, Earl, res, 513 E 4th.....	663-W
		Fitzgerald, John, res, 519 E 6th.....	497-J
		Fletcher, Charles, res, 522 W 6th.....	481-J
		Flourney & Co, Feed Store, E 5th.....	386
		Flourney, M C, res, 132 W 6th.....	248

E

Eagleston, F H, res, 611 S Main.....	411-W
East Side Drug Co, 314 E 10th.....	613
Echard, C L, res, 217 S Maple.....	559-W
Eckert, Edna, res, 116 E 9th.....	73-W
Economy Feed Store, 112 E 7th.....	438
Eddy, Mrs Merle, res, 139 W 7th.....	724-J
Edison School, West 10th.....	442
Edmonds, J L, res, 517 W 8th.....	928-J
Ehert, F B, res, 225 W 9th.....	874-W
Ekdahl, Harry, res, 200 W 10th.....	17

SUNBEAM **G** **ROCERY & TEL. 885**
SANITARY **MARKET** **TEL. 681**

HOME OF RICHELIEU AND SUNBEAM PURE FOOD PRODUCTS

BRISTOW STEAM LAUNDRY

Phone 337

WET WASH

Phone 337

Dixie Barber Shop, 130 S Main.....	713	Elias, K, res, 238 W 10th.....	273-W
Dixie Store, 118 S Main.....	677	Elias, Swap, res, 134 W 9th.....	561
Dole, J W, res, 614 East 6th.....	833-W	Ellis, W R, res, 501 E Jefferson.....	694-W
Don Hotel, 112 E 4th.....	965	Endsley, Lee, res, 504 E 8th.....	696-J
Dorris, Andrew B, res, 409 W 8th.....	928-W	ETHERICAL STUDIO , Roland Hotel Bl.....	334
Douglas, R K, res, 816 S Walnut.....	181-J	Evans, O M, res, 513 E 5th.....	421-J
Dove, J H, res, 923 S Chestnut.....	659-J	Evans, Roy, res, 209 S Elm.....	810-J
Dowdy, Will, rural, S of City.....	9533-F22	EVERGREEN FARMS , W of City.....	683
Dowler, Earl, res, 204 S Elm.....	789-W	Evers, John, rural.....	9534-F25
Dressler, C A, rural, NW of City.....	9519-F12	Ewing, F X, res, 307 E 6th.....	413-J
Dubbs, F A, res, 144 W 5th.....	810-W	Exelton, Eugene, res, 112 E 11th.....	185
Duffy, J F, res, 300 E 10th.....	228	EXIDE BATTERY STATION , 214 S Main.....	778
Dumas, G E, res, 246 W 11th.....	22-W	Exleton, Mrs Amelia, res, 110 E 11th.....	105-W
Dumas, J H A, rural, NW of City.....	9528-F2		
Dumas, M E, res, 1st and Chestnut.....	168-W		
Dunaway, M A, res, 2nd & Oak.....	41		
Duncan, R E, res, 308 E 4th.....	211-J		
Dunham, W H, res, 143½ W 10th.....	203-W		
Dunlapp, Mrs N E, res, 121 E 6th.....	1008-J		
Dunn, R W, res, 112 N Elm.....	133-J		

F

F & E Truck Co, 1st and Main.....	795
Faith, J P, res, 4th and Hickory.....	663-J

UNDERTAKING

Stubblefield & Sullivan
AMBULANCE
 Day & Night **PHONE 847**
 Residence **PHONE 544-J**

Dupree, H L, rural, W of City.....	9500-F11
Duquene Petroleum Co, NW of City.....	9528-F13
Durham, Earl, res, 235 W 4th.....	475
Durham, H L, res, East 9th.....	562-J
Dwyer, S E, Rig Contr, 409 E 3rd.....	361
Dyer, A D, res, 600 S Main.....	676-W

E

Eagleston, F H, res, 611 S Main.....	411-W
East Side Drug Co, 314 E 10th.....	613
Echard, C L, res, 217 S Maple.....	559-W
Eckert, Edna, res, 116 E 9th.....	73-W
Economy Feed Store, 112 E 7th.....	438
Eddy, Mrs Merle, res, 139 W 7th.....	724-J
Edison School, West 10th.....	442
Edmonds, J L, res, 517 W 8th.....	928-J
Ehert, F B, res, 225 W 9th.....	874-W
Ekdahl, Harry, res, 200 W 10th.....	17

FAMILY WET WASH LAUNDRY,

Walnut and Lincoln.....	744
Famous Department Store, 112 S Main.....	138
Farmer, B A, res, 339 W 5th.....	943-J
Farmers Custom Gin, 3rd Street.....	831
FARMERS GROCERY , North Main.....	5
Farnham, H P, res, 405 W 2nd.....	930-J
Ferguson, J E, res, 500 E Lincoln.....	665-J
Fesler, R H, res, 720 E 5th.....	729-J
Fessler, H B, res, 141 W 10th.....	241
Felder, Mrs A, res, 114 N Elm.....	34
Fire Station, 104 E 8th.....	88
FIRST NATIONAL BANK , 7th and Main.....	8
Fisk, J O, Taxi Co, 110 E 6th.....	500
Fisk, J O, res, 724 E 4th.....	842-W
Fitch, Earl, res, 513 E 4th.....	663-W
Fitzgerald, John, res, 519 E 6th.....	497-J
Fletcher, Charles, res, 522 W 6th.....	481-J
Flourney & Co, Feed Store, E 5th.....	386
Flourney, M C, res, 132 W 6th.....	248

SUNBEAM **G**ROCERY & **TEL. 885**
SANITARY **G**MARKET **TEL. 681**

HOME OF RICHELIEU AND SUNBEAM PURE FOOD PRODUCTS

BRISTOW STEAM LAUNDRY

Phone 337

Always at your Service

Phone 337

Gray, Dr F A, res, 205 W 7th.....	816-J
GRAY & MANN , 1st and Main.....	712
Green, W W, res, 300 N Chestnut.....	339-W
Greene, K C, res, 116 S Ash.....	571-W
Greenwood, B H, res, 142 W 8th.....	128
Greer, Wesley, rural, NW of City.....	9519-F21
Griffin, Roy C, res, 405 W 8th.....	978
Griffis, James T, Blacksmith, 106 W 4th.....	576
Griffis, James T, res, 802 S Walnut.....	777-W
Griffith, F L, res, 2nd and Walnut.....	522-J
Griffith, Joe, res, 4th and Poplar.....	405
GRIMES & CO Hdw & Furn, 208 N Main.....	319
Grimes, S R, res, 421 W 6th.....	373
Grizzard, J L, Business, Roland Hotel Bl.....	960
GROOM HARDWARE CO , 115 S Main.....	11
Groom, Margaret J, res, 503 N Main.....	464-W
Groom, M J, res, 508 E 6th.....	49
Groom, O D, 1st Natl Bank Bl.....	8
Groom, O D, res, 203 W 10th.....	597

HALLIBURTON OIL WELL CEMENT- ING COMPANY	603
Hallway, W E, res, 904 S Walnut.....	181-W
HALLPIKE STUDIO , Stone Bl.....	249
Hamilton, J H, rural, E of City.....	9516-F2
Hamilton, W F, res, 415 W 11th.....	412
Hamra, F H, res, 616 S Main.....	543-W
Hanna, Harry, res, 508 S Maple.....	709-W
Hansen, Dr G R, 11 Groom Bl.....	704
Hansen, Dr G R, res, King Apts.....	583-W
Harding, E D, rural, S of City.....	9507-F11
Harding, L B, rural, S of City.....	9507-F13
Harmon, C W, res, 421 E 2nd.....	155-W
Harmon, E L, res, 322 W 8th.....	139-W
Harriot, Ames, rural, NE of City.....	9537-F13
HARRIS, CARL , Taxi Co, 6th and Main.....	610
Harris, F O, res, 520 E 6th.....	194
Harris, J C, Business, 6th & Frisco.....	671
Harris, J C, res, 317 N Pecan.....	862-W
Harris, Paul, res, 215 E Jackson.....	777-J

UNDERTAKING

Stubblefield & Sullivan
AMBULANCE
Day & Night **PHONE 847**
Residence **PHONE 544-J**

Groom, W W, res, 327 W 10th.....	85-W
Gumm, H W, res, 232 W 10th.....	692-J
Guthrie, P A, res, 124 E 10th.....	596-W
Gypsy Oil Co (Bear Lease) SW of City.....	9526-F3
Gypsy Oil Co (Lucky Lease) E of City.....	9501-F11
Gypsy Oil Co (Warehouse) 1st & Maple.....	298
Gypsy Oil Co, 1st and Maple.....	219

H

Hadges, N J, rural, N of City.....	9523-F13
Hadlock, M, res, 220 E 3rd.....	662-W
Hafer, E C, res, 608 N Elm.....	536-J
Haines, F L, res, 401 E 7th.....	362
Hale, D D, res, 807 S Poplar.....	770-J
Haley, A C, res, 608 S Main.....	35
Hall, G W, res, 2nd and Walnut.....	409-W
Hall, O R, res, 515 W 8th.....	150-J

Harris, Thos S, res, 402 W 8th.....	240-J
Harris, W L, res, 136 S Walnut.....	347
Harris, W P, res, 211 W 2nd.....	822-J
Harrison, H H, res, 401 S Oak.....	492-J
Hartnet, C J, res, 217 W 6th.....	368
HARZ, DR GUSTAV H , 6th and Main.....	735
HAYES, P J, PLUMBING CO Laurel Hotel Bl.....	7
Hayhurst, L M, res, 915 S Poplar.....	918-J
HEALD AUTO SUPPLY , East 7th.....	680
Healds, E J, Garage, rural.....	9516-F3
Helphrey, Chas E, res, 500 E 6th.....	288
Henderson, G G, res, 409 W 9th.....	184-J
Hendricks, H G, res, 613 W 6th.....	324
Hendricks, R A, res, 413 W 2nd.....	1013-W
Henkins, Mary E, res, 312 E 3rd.....	401
Henry, J B, res, 304 S Maple.....	955-W
Henry, Jim, rural, W 12th.....	9505-F2
Henry, Rennie, res, 230 W 7th.....	654-J
Henshaw, Frank S, res, 239 W 2nd.....	158-J

SUNBEAM **G**ROCERY & **TEL. 885**
SANITARY **G**MARKET **TEL. 681**
HOME OF RICHELIEU AND SUNBEAM PURE FOOD PRODUCTS

Ford

\$155.00 DOWN

BALANCE EASY TERMS

BRISTOW MOTOR CO. Call 275

L. M. LIST, Mgr.

Fobes, L B, rural, S of City	9521-F14
Ford, Earl W, res, 116 W 11th	437-W
Ford Hardware Co. 209 N Main	62
Ford, J D, res, 533 E Washington	621-W
Ford, John W, res, 213 S Elm	648-W
Ford, W F, res, 233 W 9th	655-J
Forman, Emma, rural	9503-F2
Forman, Mike L, res, 711 S Chestnut	829-J
Foster, C E, res, 4th and Hickory	402
Foster, Mrs E O, res, 22 E 2nd	818-W
Foster, Louis, res, 716 E 1st	188
Foster, O P, res, 206 E 8th	708-J
Foster, W O, rural, S of City	9507-F4
Fox, Ed, rural, S of City	9521-F3
Fox, G E, res, 1002 S Hickory	907-W
Fox, Reese, res, 506 E 6th	491-J
FRANCE, J W. TRUCKING CONTR. 136 West 5th	124-J
Francis, H H, res, 421 E 6th	768-W
Franklin, W C, res, 510 N Main	804-J

Frix, Taylor, rural, S of City	9502-F4
Fugate, Jim, rural, E of City	9530-F14
FULLERTON-STUART LUMBER CO	604
Furrey, D M, res, 305 E 9th	895

G

Gable, Ella, res, 309 W 4th	286-J
Gallop, Dave, res, 608 E 6th	783-J
Garnier, Luther, res, 520 E 9th	372-J
Garrison, K A, res, R Freeland Apts	544-W
Gary, L L, res, 236 W 11th	77-J
Gary, O E, res, 515 W 7th	913-J
Gates, J B, res, 210 W 11th	279
GAWEY, SAM, GROCERY. Main Street	82
Gawey, Sam, res, 153 W 8th	449
Gelwick, Anna, res, 310 W 3rd	709-J
Gelwick, Ed, res, 137 W 5th	76
GENE'S PAINT SHOP, 110 W 5th	515

HIGH GRADE PETROLEUM PRODUCTS

ACCESSORIES

PHIL-MONT SERVICE CO.

WHOLESALE AND RETAIL

SECOND AND MAIN

TELEPHONE 852

Franks, H A, rural, NE of City	9537-F4
Frazier, Ben, res, East 11th	392-J
Frederick, Mrs C E, rural	591
Frederick, V, rural, S of City	9521-F23
Freeland, C L, res, 236 W 6th	108
Freeland, D M, res, 410 W 6th	785
FREELAND GASOLINE STA. 1st & Main	795
Freeland, Glen D, res, West 7th	215-J
Freeland, S P, res, 245 W 6th	110-W
Freeland, T M, res, LaVinna Apts	882-J
Freeman, H M, res, 504 W 8th	932-W
French, R A, res, 229 W 10th	531-W
Freshour, W W, res, 402 Walnut	58
FRICK-REID SUPPLY, 134 E 9th	556
Frick-Reid Supply, Ira Rockhold	487-J
Friedman, Mrs M, res, 139 W 8th	277-W
Frierson, A M, res, 204 E Washington	676-J
Frierson, W A, res, E Washington	483-W
Frisco Railway Co, Depot	51
Frisco Freight Office	741

Gibson, C O, res, 230 W 12th	939-W
Gideon, Mrs Nona, res, 317 E 8th	686-W
Giles, Chas, rural, N of City	9508-F11
Giles, W R, res, 720 1st	669-J
Gillenwater, J B, res, 409 E 8th	586-W
Gillespie, Dr C M, Office, 105½ E 7th	525
Gillespie, Dr C M, res, 309 W 5th	406
Gillespie, Curtis, res, 107 W 3rd	647-W
Gilpin, R I, res, 417 W 2nd	753-W
Glasser, Henry, res, 227 W 9th	273-J
Glennan, J S, res, 212 E 2nd	782-J
Glennan, J S, rural	9534-F24
Globe Store, 222 N Main	147
Golding, J D, res, 420 W 11th	718-J
Gorman, Vee M, res, 500 W 10th	791-W
Graham, O N, rural	9524-F2
Graham, R, rural	9530-F121
Grandin, R R, res, 412 E 7th	259
Gray, D M, res, 315 E 9th	731-J
GRAY, DR F A, Office, 1st State Bk Bldg	525

PARISIAN CLEANERS

107 E. Seventh

"SUDDEN SERVICE"

Phone 131

Ford

\$155.00 DOWN
 BALANCE EASY TERMS
BRISTOW MOTOR CO. Call 275
 L. M. LIST, Mgr.

Hensley, Jack, res, 205 W 9th.....	874-J	Hotel Antlers, 108½ S Main.....	1033
HENSON B FEED STORE 111 E 7th.....	305	HOTEL BENTON , 217½ S Main.....	1028
Henson, Basil, res, W 8th.....	724-W	HOTEL ROLAND , West 6th.....	1000
HENSON, STANLEY , res, 310 W 10th.....	845-W	Private Exchange Connecting All Rooms	
Herald's E J, Garage, rural, E of City.....	9516-F3	House, R M, res, 404 W 7th.....	234
Herman, W H, res, 130 W 8th.....	253	HOUSE, R S, LABOR SAVING MACHY	
Herndon, C C, res, Windsor Court Apts.....	390-J	307 N Main.....	72
Hess, Ben M, res, 227 E 8th.....	821-J	House, Mrs R S, res, 302 E 7th.....	106
Heskins, Squire, E of City.....	9530-F5	Howell, H J, res, 211 E 5th.....	323
HICKS & BURKS , Amer Natl Bk Bldg.....	857	Hubbard & Combs Grocery, E of City.....	9530-F33
Hicks, E J, res, 421 E 9th.....	538	Huffman, Mrs E, res, 115 S Cherry.....	986-W
Higgs, Oscar, rural.....	9510-F12	Hufford, Oscar, res, 112 W 8th.....	941-W
High School, West 10th.....	207	Hughes, E W & M S, 201 Groom Bldg.....	922
Hildebrand, C C, res, 228 W 8th.....	971-W	Hughes, James L, res, 507 W 8th.....	936-W
Hildreth, John, res, 216 S Poplar.....	854-J	Hughes, M S, res, 111 W 10th.....	127
Hill, R A, res, 4th and Elm.....	439	Hughes, M S, 201 Groom Bldg.....	922
Hillard, Mrs T B, res, 219 E 10th.....	381	Hughes, Paul, res, 138 W 8th.....	202-W
HINDERLITER TOOL & SUPPLY CO. , 134 East 7th.....	322	Hulsey, E G, res, 212 W 5th.....	499-W
Hines, R I, res, 321 E 9th.....	503-J	Humphrey, Emma, res, 301 E 6th.....	564
		Humphrey, G H, rural, N of City.....	9508-F13

FISK TIRES

PHIL-MONT SERVICE CO.
 SECOND AND MAIN TELEPHONE 852
 TIRE AND TUBE SERVICE

Hirm, George F, res, 314 W 9th.....	363-J	Humphrey, J D, res, 427 E 7th.....	59
Hoffman, A M, res, 512 E 3rd.....	492-W	Huss, C I, res, Windsor Court Apts.....	390-W
Hoffman, S G, res, 204 W 9th.....	849-J	Hutchings, J B, res, 211 W 6th.....	535
Hogg, S G, res, 226 N Elm.....	816-W	Hutchings, Shelt, rural, S of City.....	9515-F2
Hogue, H M, res, 202 E 3rd.....	911-J	Hutton, C E, res, 202 W 10th.....	445
Holland, Mrs A W, res, Windsor Court.....	962-J		
Holland, Chas B, res, 317 W 8th.....	246-J		
Holland, T H, res, East 8th.....	238-J		
HOLLIS, DR J E , Ofc, Fanny Watson Bldg.....	457		
Hollis, Dr J E, res, 504 N Maple.....	565		
HOLLY H P res, 420 W 8th.....	913-W		
Holmes, W R, res, 130 E 9th.....	493	Iddings, Frank, res, 417 W 10th.....	426-J
HOME DECORATOR , 228 W 3rd.....	908	IDEAL CLEANING WORKS , 112 E 6th.....	733
Home Laundry, 217 S Walnut.....	637	Ideal Hotel, 118½ S Main.....	839
HOME UNDERTAKING CO. , 311 N Main.....	645	Ihle, J A, res, 406 W 10th.....	1014
Horany, Oscar, res, 408 W 10th.....	635-J	Independent O & G Co, SW of City.....	9531-F3
Horn, Mr, rural.....	9532-F3	INDEPENDENT TORPEDO CO. , 236 W 7 94	
Horsley, B M, res, 416 W 10th.....	635-W	Inman, Coy L, res, 616 E 6th.....	833-J
Hoss, L B, res, 404 W 9th.....	631	International Supply (Successors to Okla Tool & Supply Co) E 9th.....	178
Hoss, L B, res, 404 W 9th.....	687	Iron Post Store, rural, S of City.....	9507-F21

PARISIAN CLEANERS

107 E. Seventh

"SUDDEN SERVICE"

Phone 131

BRISTOW STEAM LAUNDRY

Phone 337

THRIFT-SERVICE

Phone 337

J

Jackson, Fred O, res, 615 N Main	698-J
Jackson, H L, res, 115 N Poplar	456-J
JACKSON J M STORE 214 N Main	13
Jackson, J M, res, 401 W 9th	184-W
James, A N, res, 518 E 8th	773-W
James, Jessie, rural, S of City	9533-F12
Jennings, Frank, res, 222 W 3rd	803-W
Joans Millinery Shop, 209 N Main	827
Jobe, Eva S, 2nd and Maple	416-W
Johnson, Camillus, Roland Hotel Bl	278
Johnson, F M, res, 138 W 8th	924-W
Johnson, Lee J, res, 402 W 9th	269-W
JOHNSON & MILLER (F M & John R) Attorneys, Useph Abraham Bl	29
Johnson, S G, res, 317 W 9th	587-J
Johnson, S Y, rural	9530-F12
Johnson, W J, res, 514 E 7th	491-W
Jomack Oil Co, Jomack Bl	333

Katz, Sidney S, res, 238 W 6th	107
Kellerman, J W, res, 422 W 9th	193
KELLEY CLEANERS , 205 N Main	147
Kelley, A W, res, 520 E 8th	330
Kelley, Z A, res, 224 W 9th	926-W
Kelly, Albert, res, 119 E 10th	214
Keltner, J H, res, 324 W 12th	557-W
Kemp, L L, res, 401 W 6th	944-W
Kennedy, W E, res, 314 E 7th	299-W
Kenemer, J D, res, 310 W 12th	627-J
Kerines, J J, res, 4 Harris Apts	150-W
Kessinger, J H, res, 131 W 6th	254-W
Kettleson, Gilbert C, res, 118 W 4th	973-J
Keys, John, rural	9527-F12
Keys, T S, res, 921 S Oak	929-J
Kidd, J M, res, 111 E 2nd	660-J
Kilgore, Robert, rural, SW of City	9510-F4
Killinger, Hugh S, res, 203 W 9th	956-W
King, Dr E W, Phys, Watson Bl	104

UNDERTAKING

Stubblefield & Sullivan
AMBULANCE
Day & Night **PHONE 847**
Residence **PHONE 544-J**

Jones, A M, res, 416 S Walnut	911-W
Jones, G L, res, 132 W 11th	636-J
Jones, John R, rural, NW of City	9528-F11
Jones, L C, res, 213 E 9th	763-W
Jones, L L, res, Exelton Apts 11th & Main	105-J
Jones, M, Bremont Oil Co, 119 W 11th	37
Jones, Marvin L, res, 502 E 8th	503-W
Jones-Nolan Drilling Co, 222 Groom Bl	925
Jones, R L, Office, Jomack Bl	346
Jones, R L, res, North of City	377-J
Jones, Stoke, res, 117 E 11th	315
Jordan, L E, res, 206½ E 7th	397-J
Joseph, George, res, 226 W 10th	692-W
Junior High School	1019

King, Dr E W, res, 301 W 10th	815-W
King, Hazel, res, 114 N Elm	547
King Lawrence, Lumber Co, 121 E 7th	5
Kingston, C E, res, 605 E 5th	617
Kirchner, R R, res, 314 W 8th	133-J
Kizzlar, E H, res, Vickers Apts	646-J
Klingensmith, Ben, res, 507 E Jackson	702-W
Klingsmith, Chas, res, 500 E 3rd	282
Kohlman, Morris, res, 208 W 10th	906
Kopenhagen, H L, res, Windsor Court Apt	806-J
Korf, H E, res, Harris Apts, E 6th	150-J
Koury, C P, res, 712 S Main	167-W
Koury, E J, res, West 9th	589
Kramer, J C, res, 210 W 7th	590-J
Krone, C E, res, 237 W 5th	321-J
Krumrei, W E, res, 115 E 8th	769-W
Kuhlman, H, res, 304 W 11th	477-J
Kyser, Walter, res, 601 E 7th	242

K

K of P Castle, over Community State Bank	300
KATZ DEPARTMENT STORE	431

SUNBEAM **GROCERY & TEL. 885**
SANITARY **G MARKET TEL. 681**
HOME OF RICHELIEU AND SUNBEAM PURE FOOD PRODUCTS

Ford

\$155.00 DOWN
BALANCE EASY TERMS
BRISTOW MOTOR CO. Call 275
L. M. LIST, Mgr.

L

Ladd, D M, res, 709 S Chestnut.....	391	Locke, D C, res, 318 W 8th.....	937-J
Lambeth, J H, res, 121 W 10th.....	119	Loeffler, Louis, res, 420 W 6th.....	216
Lamons, H T, res, 702 E Washington.....	154-J	Lorett, L T, res, 421 E 4th.....	365-W
Laney, Frank, res, 920 S Oak.....	929-W	Lorraine Refining Co, Pipe Line Dept, North Chestnut.....	39
Latshaw, D L, res, 106 W 1st.....	543-J	Lott, Robert, rural, E of City.....	9530-F32
Latshaw, W C, res, 206 E 6th.....	183-W	Loucks, W E, res, 144 W 7th.....	585-W
Laurel Hotel, 114 E 6th.....	7	Love, C E, res, 506 E Washington.....	146-J
Laux, Frank, res, 223 W 11th.....	283	Lovett, Mrs Chas, res, 303 E 7th.....	380
LAUX & LOEFFLER Attys, Groom Bl.....	420	Lovett, R H, res, 215 N Chestnut.....	199-W
Leach, E L, Halliburton Cement Co, 225 South Poplar.....	603	Lovett, Mrs S P, res, 520 N Main.....	93
Leach, Rev W O, res, 220 E 6th.....	598-W	Lucas Welding Shop, 125 E 5th.....	506
Leake, Roy, res, 237 W 2nd.....	657-J	Lucas, J B, res, 219 E Jackson.....	258-W
Ledgewood, J E, res, 210 W 12th.....	599-J	Luman, M L, res, 321 E 7th.....	308
Ledgerwood, J S, rural, S of City.....	9515-F12	Lyons, A H, res, 501 W 8th.....	849-W
Lee Cotton Co, 125 East 8th.....	940		
Lee, Phillip, rural, NW of City.....	9528-F12		
Lee, W W, res, 420 E 6th.....	484		

M

Machlan, M E, res, 219 E 8th.....	708-W
Machlin, D A, res, 118 E 10th.....	182

HIGH GRADE PETROLEUM PRODUCTS

ACCESSORIES

PHIL-MONT SERVICE CO.

WHOLESALE AND RETAIL

SECOND AND MAIN

TELEPHONE 852

Leech, Miss Edith M, Jomack Bl.....	905	MAGNOLIA PETROLEUM CO, 402 W 1st.....	436
Leet, W W, rural, N of City.....	9508-F3	Maltby Brothers, 112½ S Main.....	734
Leming, Ora T, res, 714 S Main.....	661-J	Mann's Produce Co, 131 E 3rd.....	794
Leshner, L A, res, 418 W 11th.....	607-J	MARATHON FILLING STATION, 300 S Main.....	566
Lester, Roy, rural, N W of City.....	9519-F121	MARCEL BEAUTY SHOPPE, 207 N Main.....	400
Lewis, B M, res, 219 E Washington.....	191-W	Marcus, Mrs N, res, 318 W 9th.....	693
Lewis, Phocion, res, 307 E 3rd.....	548-W	Marcy, Henry C, res, 612 W 6th.....	851-J
LEWIS & SPOONER, Automobile Sales, 2nd and Main.....	865	Marinello Beauty Shop, 1st State Bank Bl.....	103
LIBERTY BARBER SHOP, 207 N Main.....	914	MARION MACHINE, FOUNDRY & SUPPLY CO	840
Liberty Casing Crew, 313 W 8th.....	430	MARQUETTE HOTEL, 2nd and Main.....	890
Liberty Confectionery, 5th and Main.....	984	Marrs, F N, res, 501 E 2nd.....	169
Liggett, B F, res, 200 W 5th.....	789-J	Marshall, E F, res, 202 E 7th.....	415
Liggins, Annie, Grocery, 11th & Poplar.....	772	Martin, Dr A E, Phys, Amer Natl Bk Bl.....	830
Lindsay, R B, res, 310 E 10th.....	1010	Martin, Dr C G, res, 130 E 11th.....	320
Linkhart, Roy, rural, E of City.....	9530-F23	Martin, Ed, rural.....	9530-F2
Linkhart, W R, res, 411 W 10th.....	563-J	Martin & Hathaway, Groc, Lincoln & Wal.....	408-J
List, L M, res, 215 S Poplar.....	328-J	MARTIN J P STORE 202 N Main.....	165
Livingston, D B, res, 500 W 9th.....	581-W	Martin, L C, res, 611 E 5th.....	96
Lohan, Nellie A, res, 413 E 7th.....	266-J		

PARISIAN CLEANERS

107 E. Seventh

"SUDDEN SERVICE"

Phone 131

BRISTOW STEAM LAUNDRY

Phone 337

WET WASH

Phone 337

Martin, R P, res, 212 W 8th.....	366	Meshak, Tom, res, 227 W 6th.....	215-W
Mascho, Ted, res, 228 W 9th.....	981-J	Meshek, W H, res, 231 E 8th.....	163-W
Masonic Temple, North Main.....	345	Methodist Church, 7th and Chestnut.....	27
Matthews, J M, res, 421 W 11th.....	861-J	Metcalf, Frank, res, 4 Freeland Apts.....	1009-W
Matthews, O C, res, 711 S Oak.....	919-W	Mike, Frank, res, 116 W 9th.....	265-W
Mays, Dick, res, 313 E 6th.....	162	Milburn, F M, res, 311 W 11th.....	627-W
Mays, Joseph, res, 4th and Oak.....	153	Milburn, H G, res, 407 E 9th.....	570-W
McBride, Ben D, res, 111 E 10th.....	464-J	Milburn & Sneed Agency, 110 E 8th.....	541
McCandless, E J, res, 134 E 10th.....	798-J	Miller, Hugh, res, 224 W 5th.....	263-J
McClelland, Geo W, res, 112 N Elm.....	590-W	Miller, John R, res, E 1st.....	782-W
McClendon Cafe, North Main.....	1035	Miller, W H, rural.....	9530-F24
McColm, L L, res, 508 E 7th.....	768-J	Mills, E A, res, 605 S Chestnut.....	291
McCormick, U G, res, 320 E 3rd.....	235	Mills, Irwin, rural, S of City.....	9533-F4
MC COY PLUMBING & ELECTRIC CO 104 West 8th.....	750	Mills, Mrs M E, res, 108 W 4th.....	977
MC GUTCHEON, ALEX, Teaming Contr, Chestnut and Jackson.....	609-J	MODEL CLEANERS, 107 E 5th.....	751
McDanials Grocery, 131 E 5th.....	529	Modern Boiler Works, 121 E 2nd.....	70
McEwen, L W, res, 218 W 8th.....	435-W	Modern Hotel, 219½ N Main.....	1027
McGehee, C M, res, 410 N Elm.....	583-J	Moffit, D H, res, Freeland Apts.....	879
		Montgomery, Walter, res, 308 E 6th.....	268-W
		Moore, C H, res, South Chestnut.....	736-W

UNDERTAKING

Stubblefield & Sullivan
AMBULANCE
Day & Night **PHONE 847**
Residence **PHONE 544-J**

McGehee, Mary E, res, 129 W 11th.....	463	Moore, C H, rural, N of City.....	9534-F11
McGinty, Charles, res, 119 W 4th.....	530-W	Moore, R V, res, South Pecan.....	888-W
McGuire, Mrs E, res, 328 W 12th.....	674-J	Moore, W E, Business, West 5th.....	143
McIlvaine, E L, res, 204 E 7th.....	691-W	Moore, W E, res, West 5th.....	478
McIntosh, H M, res, 327 W 11th.....	910-J	MOREHEAD, REV H K, res, 421 E 7th.....	327
McManis, M A, res, 239 W 10th.....	673-W	Morgan, J M, res, 403 E 2nd.....	157
McMillan, Geo, Office, 405 N Main.....	200	Morgan, Willie H, res, West 10th.....	758-W
McMillan, Geo, res, 404 E 6th.....	75	Morris, C J, rural, NW of City.....	9529-F13
McMurtry, A W, res, 11th and Ash.....	387	Morris, W A, res, 228 W 3rd.....	908
MC MURTRY, E B, Rig Contr, 121 E 9th.....	711	Morrison, Alma, res, 236 W 8th.....	934-J
McMurtry, E B, res, 607 S Chestnut.....	423	MORRISON, CORA & CO, 114 W 6th.....	841
McMurtry, L R, res, 112 S Oak.....	783-W	Morrison, Grace, res, 108½ W 8th.....	941-J
McNabb, D L, res, 210 S Walnut.....	256-J	Morrison, M, res, West 8th.....	269-J
McNabb, F L, res, 241 W 10th.....	22-J	Morrison, Malcolm, City Hall.....	976
McNames, T W, rural, S of City.....	9515-F111	Morrison, Mira, res, 330 W 6th.....	943-W
MC NEEL, L A, Wholesale Fruit & Vegetable Co, 307 S Main.....	195	Morrow, Howard, res, 200 E 5th.....	116-W
McNutt, C W, res, 320 N Maple.....	429	MOTOR INN GARAGE, 215 S Main.....	788
Mershon, A J, res, 211 E Lincoln.....	967-J	Mount, E E, Business, Well Bl.....	896
Mershon, C M, res, Walnut & Lincoln.....	520-J	Mount, E E, res, 500 E 1st.....	146-W

SUNBEAM GROCERY & TEL. 885
SANITARY G MARKET TEL. 681
HOME OF RICHELIEU AND SUNBEAM PURE FOOD PRODUCTS

Ford

THE UNIVERSAL CAR

\$155.00 DOWN

BALANCE EASY TERMS

BRISTOW MOTOR CO. Call 275

L. M. LIST, Mgr.

Mount, T S, res, 422 E 3rd	297
Mount, Victor T, res, 137½ W 7th	924-J
Mullens, C A, res, 315 S Poplar	458
Murray, Rev Thomas, res, 506 W 7th	862-J
Myers, F F, res, 216 E 5th	856-W
Myers, J A, res, 606 E 7th	192
Myers, Ray M, res, 510 E 7th	497-W

N

Naifeh, E T, res, 418 W 7th	697-J
Naifeh, J T, res, 400 W 10th	426-W
NAIFEH WHOLESALE GROCERY CO. 222 West 2nd	432
Nance, C L, res, 322 E 2nd	168-J
Nance, J L, Justice of Peace, City Hall	880
Nanney, T E, res, 313 E 3rd	212-J
NATIONAL SUPPLY CO. , East 6th	641

O

OAK STREET FILLING STATION. 1st and Oak	358-W
O'Danley, D H, rural, E of City	9530-F16
Oil City Feed Store, 504 E 2nd	638
Oil City Tool Co, 125 E 6th	502
Oil Well Supply Co, E 6th	671
OILIFT CO. , 122 West 6th	950
Okla Gas & Electric Co, 301 E 9th	705
Okla Gas & Elec Co, 127 W 7th	630
Oklahoma Hotel, 113½ S Main	1007
Okla Natural Gas Co, rural	9512-F4
Okla Natural Gas Co, NW of City	9512-F14
Okla Natural Gas Co, NW of City	9512-F3
Okla Southwestern Railway Co	655
OKMULGEE LUMBER CO. , 3rd & Chestnut	479
Olean Petroleum Co, Groom Bl	32
Olean Petroleum Co, NW of City	9512-F11
Oliver, G W, res, 118 S Pecan	986-J

FISK TIRES

PHIL-MONT SERVICE CO.

SECOND AND MAIN TELEPHONE 852
TIRE AND TUBE SERVICE

Nave, D B, res, 303 E 9th	904-J
Neal, Mrs Mary F, res, 411 W 7th	532-J
Newell, C E, res, 927 S Poplar	918-W
Newell, Grace, res, 215 E 2nd	605-J
Newton, Mrs W L, res, 218 W 7th	716-J
Niccum, C F, res, 904 S Hickory	901-W
Nichols, J B, res, 420 W 7th	697-W
Nichol's 10c Ctore, N Main	868
Nichols, L M, res, 218 W 5th	90
Nimmo, Mrs Lucy C, res, 320 W 7th	654-W

NOBBY CLEANERS & DYERS,

311 N Main 118

NO-D-LAY CLEANERS 111 W 6th 310

Noland, W T, res, 406 W 11th 1016

North Bristow Gin, 10th & Railroad 30

NORTHWESTERN GROCERY,

8th and Maple 689

Nowata Oil & Refg Co, N of City 9534-F5

NuSho Amusement Co, South Main 595

Omara, J C, res, 419 E 5th	614
Oriental Paint Shop, 105 W 5th	738
Osteen, Jack, res, 125 E 2nd	643-W
Otis Hotel, 127½ South Main	759
Overstreet, John W, Business, 6th & Main	349
Overstreet, John W, res, 521 E Lincoln	754-W
Overturf, E H, res, 12th and Ash	557-W
Owens, W C, res, 314 W 9th	927-W
Owens, Will, rural	9533-F11

P

Paddock, E T, res, 120 W 9th 265-J

Page, R B, res, 321 W 6th 83

PALACE CLOTHING CO., 105 N Main 237

PALACE DRUG STORE, South Main 47

PALACE DRUG STORE, (Pres Dept)
South Main 99

Palace of Sweets, 120 South Main 863

PARISIAN CLEANERS

107 E. Seventh

"SUDDEN SERVICE"

Phone 131

BRISTOW STEAM LAUNDRY

Phone 337

Always at your Service

Phone 337

PARISIAN CLEANERS , 107 E 7th.....	131
Park, B E, res, 413 W 8th.....	290-J
Parker, Geo H, res, 413 E 7th.....	956-W
Parker, Stella, res, 236 W 8th.....	369-J
Parkersburg Rig & Reel Co, 142 E 11th.....	545
Parks, M C, res, 309 E 8th.....	539-W
Parrott, C E, res, 612 W 5th.....	190-J
Parson, Harry H, res, 1st and Poplar.....	409-J
Partner, W S, res, 108 E 2nd.....	244-J
Patton, Dewey, res, 524 E Washington.....	754-J
Patton, Lola, res, 419 E 10th.....	894-J
Payne, C R, res, 408 W 8th.....	837-W
Peacock, Ed, res, 140 W 6th.....	307
Peacock, Gray, res, 116 E 11th.....	510
Pebrenat, J H, res, 617 E 4th.....	250-W
Peck, H W, res, 208 E Lincoln.....	907-J
Pemberton & Thomas, rural.....	9515-F11
PENNY, J G CO , 203 N Main.....	523
PERFECTION BAKING CO , 211 S Main.....	970
Peters, J E, res, 7th & Chestnut.....	26

Ponds, Lula, rural.....	9544-F2
Poplar Cafe, South Main.....	517
Porter, Alma, res, 309 E 2nd.....	97-J
Porter, Robert Clifford, res, 420 W 9th.....	929-J
Post Office Confectionery, 113 E 8th.....	814
Post Office Filling Station, Opposite P O.....	651
Potter, Mrs C D, res, 137 W 5th.....	649-J
Potters Oil Co, 412 E 4th.....	884
POUNDERS & PARDOE Attys, 207 Groom.....	459
Pounders, L K, res, 143 W 8th.....	582-J
Pounds, Ed, Mill & Cabinet Shop, 1st and Walnut.....	244-W
Powell, F, res, 617 S Chestnut.....	154-W
Prairie Oil & Gas Co, Wrhse, E 1st.....	575
Prairie Pipe Line Co, Office, Groom Bl.....	407
Prairie Pipe Line Co, SE of City.....	217
Prairie Pipe Line Co, E of City.....	9538-F2
Prall, E Q, res, 113 W 8th.....	148
Price, L L, res, 131 W 10th.....	245
Price, R C, res, 409 E 6th.....	316

UNDERTAKING

Stubblefield & Sullivan
AMBULANCE
Day & Night **PHONE 847**
Residence **PHONE 544-J**

Peters Petroleum Co, NW of City.....	9529-F4
Peters, R G, res, 129 E 10th.....	554
Pettigrew, Chas, res, 325 W 6th.....	81-J
Phelps, W S, res, 206½ E 7th.....	299-J
Phillipi, W P, rural.....	9533-F2
Phillipi, W R, rural.....	9519-F11
Phillips, Harmon, res, 611 W 8th.....	193-W
Phillips Petroleum Co, 115 W Jackson.....	844
Phillips, William, res, 415 W 6th.....	428-W
PHIL-MONT SERVICE CO , 2nd & Main.....	852
PICKERING LUMBER CO , 133 E 7th.....	226
Pickett, Mrs Geo R, res, 403 S Elm.....	803-J
PIERCE PETROLEUM CORP , E 5th.....	504
Pike, Robert, rural.....	9528-F3
Pioneer Drug Co, 109 N Main.....	38
Piper, E D, rural.....	9530-F11
Plowman, Mrs M J, res, 702 S Main.....	875-J
PLUMMER & COLE , Auto Painters, 6th and Walnut.....	303
Pollock, Mrs M M, res, 130 W 4th.....	233

Prichett, M F, rural.....	9537-F2
PRODUCERS LUMBER CO , 112 W 2nd.....	550
Producers Supply & Tool Co, 135 E 10th.....	63
Producers Tank Co, 404 W 9th.....	687
Progress Hotel, Main.....	1020
Propst, W O, res, 245 W 9th.....	864-J
Pugh, Mrs Byron, res, 318 W 9th.....	927-J
Pulaski Oil Co, rural.....	9506-F2
Pulaski Oil Co, rural.....	9506-F4
Pulaski Oil Co, Loading Rack.....	9506-F11
Pullman Lunch, 110 N Main.....	446
Purdy, A H, res, 122 E 11th.....	23
PURDY, C H , Insurance, 119 N Main.....	24
Purdy, C H, Office, 119 N Main.....	123
Purdy, C H, res, 6th and Pecan.....	961-W
PURDY D L Real Estate, 119 N Main.....	24
Purdy, I B, res, 304 E 8th.....	145-W
PURDY & SON INS CO , 119 N Main.....	24
Purdy, Dwight L, res, 517 N Main.....	495-W
Pure Oil Co, rural.....	9526-F11

SUNBEAM **G** **ROCERY & TEL. 885**
SANITARY **MARKET** **TEL. 681**
HOME OF RICHELIEU AND SUNBEAM PURE FOOD PRODUCTS



\$155.00 DOWN

BALANCE EASY TERMS

BRISTOW MOTOR CO. Call 275

L. M. LIST, Mgr.

Purity Market & Grocery, 226 N Main..... 700
Pyle, B F, res, 510 E 8th..... 375

Q

QUAKER DRUG CO., 120 S Main..... 725
QUAKER DRUG CO (Pres Dept)
120 South Main..... 740

R

RABORN MOTOR CO., 124 E 7th..... 871
Radle, H L, res, 124 W 11th..... 437-J
Rafferty, M W, res, 114 S Pecan..... 325-W
Ragland, J H, res, 519 W 8th..... 290-W
Ragsdale, Lewis, rural..... 9544-F2
Ragsdale Sons, Undertakers, 316 E 10th..... 645
Raines, G W, res, 241 W 6th..... 379-J

Regal Hotel, 126½ W 6th..... 1024
Remy, L J, res, 3 Windsor Court Apts..... 797-W
Republic Supply Co, East 6th..... 166
REYNOLDS, DR E W, Office, 1st St Bk Bl 48
Reynolds, Dr E W, res, 414 W 6th..... 198
Reynolds, F M, res, 314 E 8th..... 904-W
Rhinehart, Harry A, rural..... 9534-F32
Rhodes, G F, res, 225 S Poplar..... 603
Richardson, E B, res, 712 S Hickory..... 756-W
Richardson, E H, res, 221 S Maple..... 239-W
Ridgeway, G B, res, 521 E 9th..... 656-J
Ridinger, C P, res, 1st and Chestnut..... 171
Riggs, H D, res, Lavina Apts..... 882-W
Riley, J W, res, R L Jones Place..... 377-W
Riley Petroleum Co, N of City..... 870
Rippy, E C, res, 319 E 9th..... 731-W
Rivers, J B, Insurance & Real Estate,
120 South Main..... 858
Roach, G T, res, 315 W 7th..... 67-J
Roberds, L R, res, 140 E 3rd..... 161

HIGH GRADE PETROLEUM PRODUCTS

ACCESSORIES

PHIL-MONT SERVICE CO.

WHOLESALE AND RETAIL

SECOND AND MAIN

TELEPHONE 852

RALLS, DR R L, Dent, Over Rexall Drug 611
Ralls, Rr R L, res, 505 W 7th..... 357-W
Randall, A A, res, 508 E 3rd..... 255
Rayburn, Nellie, res, 138 E 7th..... 456-W
RAZOOK GROCERY, 317 N Main..... 281
Rebstein, C E, res, 417 W 7th..... 837-J
Rebstein, Tom D, Ins & Real Estate,
107 W 6th..... 528
Rebstein, Tom D, res, 519 W 7th..... 511-W
Red Ball Casing Crew, 414 E 2nd..... 911
Red Bank Oil Co, rural..... 9512-F2
REDDINS, T M, Grocery & Market,
211 South Main..... 344
Reddin, T M, rural..... 9534-F15
Redding, R M, res, 314 W 9th..... 953
Reed, L, res, 233 W 8th..... 1018-J
Reedy, Mrs A, res, 112 N Elm..... 721
Reeves, C L, res, 319 W 11th..... 910-W
REGAL BATTERY STATION, W 6th..... 518
Regal Garage, 126 W 6th..... 518

Roberds, Ralph J, res, 136 E 3rd..... 829-W
Roberts, Arthur, rural..... 9508-F21
Roberts, Miss Bernice, res, 211 W 11th..... 557-J
Roberts Boarding House, 215 W 7th..... 625
Roberts, John, res, 516 E 8th..... 488
Robertson, C W, res, 200 E 5th..... 164
Robinson, F N, res, 136 E 7th..... 886-J
Robinson, Mary E, res, 529 E 2nd..... 364
Rockhold, Ira, res, Vickers Apts..... 487-J
ROGERS LUMBER CO., 116 W 7th..... 33
ROLAND HOTEL CO., West 6th..... 1000
Private Exchange Connecting all rooms
ROLAND OIL CO., 122 W 6th..... 950
Private Exchange Connecting all Depts.
Roland Oil Co, Refg Dept, N of City..... 652-J
Roland Pharmacy, Roland Hotel Bl..... 287
Roland Taxi Co, Roland Hotel..... 102
Roland, Virgil, res, 309 E 5th..... 296
Roland, W S, rural..... 9533-F14
Rollestone, A A, res, 115 E 12th..... 304

PARISIAN CLEANERS

107 E. Seventh "SUDDEN SERVICE" Phone 131

BRISTOW STEAM LAUNDRY

Phone 337

Rough Dry Service

Phone 337

Rosander, V, rural	9519-F111
Ross, O G, res, 121 W 5th	190-W
Ruark, Chas, res, 231 W 10th	531-J
Rudman, N, res, 217 W 8th	551
Rumbaugh, G N, Drilling Contractor	629
Runyan, A F, res, 201 W 6th	714-J
Ryland, H S, res, 505 W 11th	933-W
RYON, GENE , Paint Shop, 10 W 5th	515
Ryon, Gene, res, 814 S Chestnut	142-J

S

S & M PHARMACY 211 N Main	555
S & S Transfer Co, East 7th	1004
Salmon, H W, Grocery, 133 E 5th	6
Salmon, J R, res, 310 S Walnut	433
Salter, Alma, res, 220 W 4th	125-W
Salvation Army, 223 E 8th	354-W
Sanford, W E, res, 211 W 12th	673-J

Sears, Ira, res, 228 E 2nd	818
Sears, W H, res, 211 N Maple	916
Sehested, Sam, res, 126 E 10th	698-V
Self, John, rural	9537-F1

SELF SERVICE GROCERY & MARKET,

Roland Hotel Bldg	6
Seney, W A, res, 324 W 12th	557-V
Seney, W A, rural	9508-F
Senter, Alvin, res, 2nd & Oak	134-V
Senter, H W, res, 320 S Walnut	824-V
Senter, R F, res, 509 E 6th	31
Senter, Luther, res, 143 W 7th	18

SENTERS TRANSFER CO, 143 W 7th

Seskey, J F, res, 910 S Hickory	901
Settle, Chas A, res, 425 W 11th	599-V

SHADY CORNER SERVICE STATION,

11th and Main	80
Shaffer, G C, res, 145 W 5th	470-W
Shaffer Oil Co Midwest Station, SW of City	9526-F

UNDERTAKING

Stubblefield & Sullivan
AMBULANCE
Day & Night PHONE 847
Residence PHONE 544-J

SANITARY GROCERY & MARKET,

115 North Main	885
Sartin, R L, res, 403 E 9th	306
Schrack, Jess, res, 211 E 5th	524-J
Schrader, Dr Chas, Office, Schrader Bldg	44
Schrader, Dr Chas, res, 420 E 8th	144

SCHRADER DR L B Dentist,

211½ N Main	808
Schuster, P F, res, 501 W 10th	94

SCOTT ELECTRIC CO, 106 S Main

Scott, Geo, res, 802 S Main	642-W
Scott, H L, res, 510 S Walnut	522-W
Scott, H W, res, 221 E 6th	260-J
Scott, Mrs H W, res, 217 E 6th	260-W
Scott, Mrs H W, res, 219 E 5th	342

SEARCEY, J V, Jeweler, 7th & Main

Searcey, J V, res, 611 N Elm	341-J
Searles, L T, Grocery, 1st and Oak	727
Sears, B E, res, 7 S Hickory	578-W
Sears, Miss Dora, res, 517 E 2nd	469-J

Shaffer Oil & Refining Co (McIntosh Lease) East of City	9501-F4
--	---------

Shaffer Oil & Refining Co, Warehouse,	688
---------------------------------------	-----

Shaffer Oil & Refining Co (Williams Lease) South of City	9526-F2
---	---------

SHAMOS DRY GOODS, 204 N Main

Shamos, S, res, 143 W 6th	585-J
Sharp, A J, res, 216 S Poplar	854-W
Sharp, J F, res, 611 N Main	309

Sheriff's Office, City Hall	975
-----------------------------	-----

Sherman, V A, res, 514 E 5th	365-J
------------------------------	-------

Shibley, Wm, res, 327 W 9th	594-W
-----------------------------	-------

Shields, Mrs Sallie, res, 322 E 7th	496
-------------------------------------	-----

Shilling, Forest L, res, 412 E 4th	774-W
------------------------------------	-------

Shipman, H E, rural, SW of City	9520-F4
---------------------------------	---------

Shoemaker, S S, res, 335 W 5th	317-J
--------------------------------	-------

Shonfield, H, rural	9534-F21
---------------------	----------

Shope, W A, res, 215 E Jefferson	444-W
----------------------------------	-------

Silver, Charles, res, 209 W 9th	864-W
---------------------------------	-------

SUNBEAM **G**ROCERY & **TEL. 885**
SANITARY **G**MARKET **TEL. 681**

HOME OF RICHELIEU AND SUNBEAM PURE FOOD PRODUCTS



\$155.00 DOWN

BALANCE EASY TERMS

BRISTOW MOTOR CO. Call 275

L. M. LIST, Mgr.

SIMPSON BROS PLUMBING CO.

126 W 9th..... 720

Simpson, J J, res, Exelton Apts..... 572-W

Sims, F I, res, East 5th..... 21-W

Sinclair Oil Co (Lucy McDaniel Lease)..... 9522-F2

Sinclair Pipe Line Co, 505 S Main..... 703

Sines, R L, res, 625 E 4th..... 644-W

Singer Sewing Machine Co, 107 W 5th..... 749

SISLER & SISLER, DRs, Phys.

Anderson & Gilland Drug Co Bl..... 900

Sisler, Dr G W, res, 119 W 5th..... 915

SISLER, DR W H, res, 119 W 5th..... 915

Stutler, Estelle, res, 301 E 8th..... 414

Skelly Oil Co, South Booster Station,

Rural..... 9540-F6

Skelly Oil Co, Loading Rack, rural..... 9540-F14

Skelly Oil Co, North Booster Station..... 9540-F22

Skelly Oil Co, rural..... 9540-F2

Skelley Oil Co, rural, S of City..... 9540-F3

Skelley Oil Co, rural, S of City..... 9540-F4

Skelley Oil Co, rural, S of City..... 9540-F5

Snedden, R R, res, Freeland Apts..... 544-W

Sneed, L B, res, 505 W 11th..... 508-W

Snoots, W F, res, Freeland Apts..... 769-J

Snorgrass, Dr W F, res, 502 W 6th..... 117

SNYDER & WILSON, 221 Groom Bl..... 717

S W BELL TELEPHONE CO

Manager's Office..... 170

Wire Chief..... 0

Speer, J M, res, 314 E 8th..... 656-W

Spencer & Wilson Mkt & Groc, 226 N Main 701

Spencer, C A, res, East 8th..... 137

Spooner, Walter, res, 136 E 11th..... 668-J

Spurlock, A, res, 502 E 7th..... 682-W

Spurrier Lumber Company, 212 S Main..... 213

St Louis San Francisco Ry, W Bristow Yd 848

Staffen, E A, rural, N of City..... 9519-F14

STAG CLUB, 117 S Main..... 743

Stansberry, J H, rural, S of City..... 9521-F13

Staples, R M, rural, E of City..... 9536-F2

Stark, Lee E, Business, 5th and Oak..... 742

FISK TIRES

PHIL-MONT SERVICE CO.

SECOND AND MAIN TELEPHONE 852
TIRE AND TUBE SERVICE

Skelley Oil Co, rural, S of City..... 9540-F13

Skelley Oil Co, rural, S of City..... 9540-F21

Slater Bros, 522 E 7th (rear)..... 710

Slocum, E R, res, 401 E 8th..... 539-J

Slover, J L, res, 125 E 3rd..... 889-W

Slyman, D J, res, 229 W 7th..... 971-J

Slyman, Dub, res, West 7th..... 592-W

Slyman & Saab, North Main..... 84

Smith, E F, res, 411 W 11th..... 666-W

Smith, Chas B, Druggist, 141 W 11th..... 341-W

Smith, D J, res, 113 N Chestnut..... 413-W

Smith, Douglas O, res, 213 W 5th..... 851-W

Smith, Lloyd L, Atty, 7 1st State Bank Bl..... 494

Smith, Marsh, res, 222 W 3rd..... 657-J

Smith, S M, res, 2nd and Walnut..... 453-W

Smith, W H, res, 421 E 8th..... 586-J

Smoke House Club, East 7th..... 745

SMOOT, DR R E, Ofc, Fannie Watson Bl 505

Smoot, Dr R E, res, Lavinna Apts..... 882-W

Steele, C W, Insurance, Groom Bl..... 921

Steele, C W, res, 414 W 9th..... 929-W

Stephens, C H, res, 212 E 2nd..... 782-J

Stevens, J E, res, 515 E 7th..... 695-W

Stewart, Hazel, res, 305 N Elm..... 582-W

Stewart, Miss Kate, res, 314 E 2nd..... 699-J

Stewart, Mrs Pearl, res, 516 W 8th..... 511-J

Stiles, Arthur, res, 217 W 9th..... 111-W

Stinnett, Clara, res, 414 S Chestnut..... 877-J

STOCKTON, DR J W, Office, 106 E 6th..... 338

Stockton, Dr J W, res, South Walnut..... 744

Stoker, C H, res, 140 W 5th..... 584-W

Stone, A H, Office, 6th and Main..... 623

Stone, A H, Hardware, 6th and Main..... 18

Stone, A H, res, 404 E 5th..... 328-W

Stone, L, res, 316½ W 9th..... 1018-W

Stone, R M, res, 117 W 3rd..... 474-W

STORAGE BATTERIES EXIDE,

214 South Main..... 778

Stout, Van D, Office, 110 W 6th..... 126

PARISIAN CLEANERS

107 E. Seventh

"SUDDEN SERVICE"

Phone 131

BRISTOW STEAM LAUNDRY

Phone 337

Rough Dry Service

Phone 337

Stout, V D, res, 321 E 5th..... 174

Stover, R W, res, 304 W 8th..... 934-W

Strother, W O, res, 510 W 7th..... 714-W

STUBBLEFIELD & SULLIVAN, Funeral
Directors & Embalmers, North Main..... 847

STUDEBAKER AGENCY, 124 E 7th..... 871

Sullivan Bros Cash Grocery, 131 E 5th..... 196

Sullivan, M E, Undertaker, 11th & Main..... 544-J

SUNBEAM SANITARY GROCERY
& MARKET, South Main..... 681

Swafford Grocery, 617 N Maple..... 612

Swafford, H S, res, W 12th..... 939-J

Symonds Co, The, 412 South Elm..... 784

Symonds Co, The, 412 South Elm..... 573

Symonds, W S, res, West 10th..... 618-J

T

Taylor, Alzina, res, 136 W 4th..... 441-W

Taylor, Chas, rural..... 9522-F2

Tidrow, R E, res, 518 E Washington..... 62

Todd, Earl, res, 7th and Walnut..... 1008

Tolle, O S, res, 311 W 9th..... 99

Tolleson, Cleve, res, 317 N Hickory..... 91

TOMLINS CONFECTIONERY, 105 N Main..... 969

Tomlins, H V, res, 240 W 9th..... 969

Transcontinental Oil Co, Office, 214 E 9th.....

Transcontinental Oil Co, 216 E 9th.....

Transcontinental Oil Co, rural..... 9511

Transcontinental Oil Co, E of City..... 9511

Transcontinental Oil Co, rural..... 9528

Transcontinental Oil Co, Prod Dept, East of City..... 9511-F

Transcontinental Oil Co, Prod Dept Foreman..... 9511-F

Transcontinental Casing Head Dept..... 9511

Transcontinental Oil Co, Geo C Ellington, Superintendent..... 9511-F

Transcontinental Oil Co, Prod Dept, Field Office..... 9511

UNDERTAKING

Stubblefield & Sullivan
AMBULANCE

Day & Night PHONE 847

Residence PHONE 544-J

Taylor, Geo W, res, 139 E 11th..... 798-W

Taylor, John K, res, 404 E 3rd..... 272-J

Taylor, Lucille, res, 2 Harris Apts..... 183-J

TAYLOR, THE TAILOR, 726 E 5th..... 729-W

Temple Hotel, 301 S Walnut..... 465

Terry, J G, res, 210 W 3rd..... 822-W

Terry, S L, res, 302 East 8th..... 339-J

Texas Co, The, 2nd and Elm..... 771

Thomas, A H, res, 421 E 3rd..... 155-W

Thomas, Allys, res, 228 W 3rd..... 657-W

Thomas, D W, res, 504 E 8th..... 570-J

Thompson, Ed, res, 604 S Main..... 979-W

Thompson, L F, res, West 6th..... 832-J

Throne, H C, res, 501 E 1st..... 350-J

Thurman, E J, res, 303 E 5th..... 86

Tibbens, C G, Oil Co, rural..... 9520-F2

Tibbens, C G, Oil Co, rural..... 9520-F3

Tidal Oil Company, 218 E 8th..... 264

Tidal Oil Co (Nancy Tiger Lease)..... 9530-F5

Transcontinental Oil Co, Refinery, North of City..... 1

Turner, D W, res, 210 E Jackson..... 659-

Turner, Jeff, res, Lincoln and Chestnut.....

Turner, Jewel M, res, 108 S Oak..... 447

Turner, Y J, res, 319 S Poplar..... 776-

Turvey, Joseph, res, 142 W 11th..... 203

Twin State Oil Company, rural..... 9535-

Tye, H H, res, 501 W 10th..... 563-

U

Ulin, Frank, res, 315 N Hickory..... 238-

V

Vance, Ollie, res, 125 E 2nd..... 643-

VANITY FAIR BEAUTY SHOPPE, 128 S Main..... 7

VanNoy, Walter W, res, Windsor Court Ap797

SUNBEAM GROCERY & SANITARY G MARKET

TEL. 885

TEL. 681

HOME OF RICHELIEU AND SUNBEAM PURE FOOD PRODUCTS

Ford

\$155.00 DOWN
BALANCE EASY TERMS
BRISTOW MOTOR CO. Call 275
L. M. LIST, Mgr.

Vanorsdale, F G, rural.....	9533-F121	Watkins, R I, res, 107 N Oak.....	682-J
VanSickle, B C, res, 503 E 8th.....	912-W	Watrous, R O, res, 411 E 9th.....	257
VAN TUYL, ARDO , Rig Contr, 740 E 4th.....	620	Watson, E C, res, West 7th.....	944-J
Vantuyt, H G, rural, E of City.....	9524-F2	WATSON, DR A T , Dentist, 6th & Main.....	42
Vaughn, J H, res, West 4th.....	584-J	Watson, Dr A T, res, E 7th.....	527
Vick, J E, res, East 7th.....	152	WATSON MISS FANNIE Ladies Ready- to-Wear and Millinery, 2 N Main.....	209
Vickers Cotton Co, East 4th.....	802	Watson, J A, Atty, over Anderson & Gilliland Drug Store.....	289
Vickers, J C, res, West 11th.....	57	Watson, J A, res, 415 W 6th.....	579-W
Victor Gasoline Company, rural.....	9539-F2	Watson, V I, res, 127 W 6th.....	428-J
Victor Gasoline Co, N of City.....	9541-F2	Weaver, J E, res, 401 E 3rd.....	574-J
Vincent, J M, res, 302 W 8th.....	369-W	Weber, C F, res, 201 W 5th.....	853-W
Vincent, J M, Jr, res, 508 W 8th.....	357-J	Weekly, C M, rural.....	9532-F11
Voelkel, K R, res, 611 N Main.....	384	Welder, C C, res, Chestnut & Washington.....	662-J
W		Wells, Dr J M, Schrader Bl.....	80
W B Store, M Specter, Mgr, 125 S Main.....	210	Wells, Dr J M, res, 314 W 10th.....	267
Waite-Phillips, Office (Valley Winn).....	9501-F2		

HIGH GRADE PETROLEUM PRODUCTS	ACCESSORIES
PHIL-MONT SERVICE CO.	
WHOLESALE AND RETAIL	
SECOND AND MAIN	TELEPHONE 852

Waite-Phillips, Office, 312 E 2nd.....	639	West, Chas, res, 304 E 4th.....	95
Walde, R L, res, 405 W 10th.....	85-J	West, Mrs Eva D, res, 210 N Pecan.....	932-J
Walker, D D, res, 235 W 10th.....	77-W	West, L C, res, American Natl Bk Bl.....	19
WALKERS GROCERY , Newby Route.....	9502-F12	West, L C, res, 406 W 9th.....	516-J
Walker, J H, rural, Newby.....	9502-F6	WESTERN UNION TELEGRAPH CO 106 E 7th.....	371
Walker, S C, res, 122 W 7th.....	378	Western, William, res, 806 S Main.....	661-W
Walker, S T, res, 116 S Ash.....	832-W	Wheatley, Homer, res, 241 W 10th.....	109-J
Wallace, John C, res, Windsor Court Apt.....	390-J	Wheeler, Andrew, res, 604 S Walnut.....	223
Wallace, V A, res, 404 W 8th.....	240-W	Wheeler, Henry, rural.....	9534-F2
Walling, H A, res, 521 N Main.....	495-J	Wheeler, Oscar, Garage, rural.....	9534-F111
Walling, W O, rural, NW of City.....	9528-F4	Whitaker, I L, res, East 8th.....	132
Ward, C G, rural.....	9508-F4	Whitaker, J R, rural.....	9532-F2
Ward, H, res, 241 W 4th.....	559-J	White, J B, rural.....	9507-F2
Ward, J R, res, E Jefferson.....	258-J	White Oil Corp, E of City.....	9530-F6
Washbourn, E J, res, 609 W 8th.....	546-J	White Way Barber Shop, N Main.....	404
Washington School Building, 1st & Hickory.....	227	Whittis, J J, res, 301 E 4th.....	552-W

PARISIAN CLEANERS

107 E. Seventh "SUDDEN SERVICE" Phone 131

Ford

\$155.00 DOWN

BALANCE EASY TERMS

BRISTOW MOTOR CO. Call 275

L. M. LIST, Mgr.

Vanorsdale, F G, rural..... 9533-F121
 VanSickle, B C, res, 503 E 8th..... 912-W
VAN TUYL, ARDO, Rig Contr, 740 E 4th..... 620
 Vantuyt, H G, rural, E of City..... 9524-F2
 Vaughn, J H, res, West 4th..... 584-J
 Vick, J E, res, East 7th..... 152
 Vickers Cotton Co, East 4th..... 802
 Vickers, J C, res, West 11th..... 57
 Victor Gasoline Company, rural..... 9539-F2
 Victor Gasoline Co, N of City..... 9541-F2
 Vincent, J M, res, 302 W 8th..... 369-W
 Vincent, J M, Jr, res, 508 W 8th..... 357-J
 Voelkel, K R, res, 611 N Main..... 384

W

W B Store, M Specter, Mgr, 125 S Main..... 210
 Waite-Phillips, Office (Valley Winn)..... 9501-F2

Watkins, R I, res, 107 N Oak..... 682-J
 Watrous, R O, res, 411 E 9th..... 257
 Watson, E C, res, West 7th..... 944-J
WATSON, DR A T, Dentist, 6th & Main..... 42
 Watson, Dr A T, res, E 7th..... 527
WATSON MISS FANNIE Ladies Ready-
 to-Wear and Millinery, 2 N Main..... 209
 Watson, J A, Atty, over Anderson &
 Gilliland Drug Store..... 289
 Watson, J A, res, 415 W 6th..... 579-W
 Watson, V I, res, 127 W 6th..... 428-J
 Weaver, J E, res, 401 E 3rd..... 574-J
 Weber, C F, res, 201 W 5th..... 853-W
 Weekly, C M, rural..... 9532-F11
 Welder, C C, res, Chestnut & Washington..... 662-J
 Wells, Dr J M, Schrader Bl..... 80
 Wells, Dr J M, res, 314 W 10th..... 267

HIGH GRADE PETROLEUM PRODUCTS

ACCESSORIES

PHIL-MONT SERVICE CO.

WHOLESALE AND RETAIL

SECOND AND MAIN

TELEPHONE 852

Waite-Phillips, Office, 312 E 2nd..... 639
 Walde, R L, res, 405 W 10th..... 85-J
 Walker, D D, res, 235 W 10th..... 77-W
WALKERS GROCERY, Newby Route..... 9502-F12
 Walker, J H, rural, Newby..... 9502-F6
 Walker, S C, res, 122 W 7th..... 378
 Walker, S T, res, 116 S Ash..... 832-W
 Wallace, John C, res, Windsor Court Apt..... 390-J
 Wallace, V A, res, 404 W 8th..... 240-W
 Walling, H A, res, 521 N Main..... 495-J
 Walling, W O, rural, NW of City..... 9528-F4
 Ward, C G, rural..... 9508-F4
 Ward, H, res, 241 W 4th..... 559-J
 Ward, J R, res, E Jefferson..... 258-J
 Washbourn, E J, res, 609 W 8th..... 546-J
 Washington School Building, 1st & Hickory..... 227

West, Chas, res, 304 E 4th..... 95
 West, Mrs Eva D, res, 210 N Pecan..... 932-J
 West, L C, res, American Natl Bk Bl..... 19
 West, L C, res, 406 W 9th..... 516-J
WESTERN UNION TELEGRAPH CO
 106 E 7th..... 371
 Western, William, res, 806 S Main..... 661-W
 Wheatley, Homer, res, 241 W 10th..... 109-J
 Wheeler, Andrew, res, 604 S Walnut..... 223
 Wheeler, Henry, rural..... 9534-F2
 Wheeler, Oscar, Garage, rural..... 9534-F111
 Whitaker, I L, res, East 8th..... 132
 Whitaker, J R, rural..... 9532-F2
 White, J B, rural..... 9507-F2
 White Oil Corp, E of City..... 9530-F6
 White Way Barber Shop, N Main..... 404
 Whittis, J J, res, 301 E 4th..... 552-W

PARISIAN CLEANERS

107 E. Seventh

"SUDDEN SERVICE"

Phone 131

BRISTOW STEAM LAUNDRY

Phone 337

We use soft Water

Phone 337

Whyte, R T, res, 312 W 10th.....	633-J	Wiseman, Mat, rural.....	9521-F3
Wickham, W F, rural.....	9545-F2	Witter, E G, Roland Hotel Bl.....	334
Wilburn, C, res, Jackson and Oak.....	699-W	Wolfe, H T, Office, 110 W 6th.....	14
Wilcox, H F, Office, 219 E 9th.....	311	Wolfe, H T, res, 505 W 6th.....	454
Wilde, C A, res, 232 W 8th.....	916-W	Wolfe, L M, res, 405 E 5th.....	79
Wilkinson, J L, res, 405 S Oak.....	669-W	WOLFE MERCANTILE CO. Main.....	36
WILLARD BATTERIES , Regal Garage.....	518	Wolfe Oil Corp, E of City.....	9527-F2
Willard, G W, res, 200 E Jackson.....	444-J	Wolfe Oil Corp, Community St Bk Bl.....	14
Williams, Dr Carl, Office, 308½ N Main.....	218	Wolfe, W E, res, 208 E 7th.....	588-W
Williams, Dr Carl, res, 225 W 12th.....	294-W	Wolverine Oil Company, rural.....	9504-F2
Williams Casing Crew, 132 W 4th.....	892	Woods, Lula, res, East 11th.....	385-J
Williams, Eula, res, 401 E 6th.....	156-J	Woody, H B, res, 509 E 7th.....	159
Williams, Gary & Hughes, 201 Groom Bl.....	922	Wright, James H, rural.....	9519-F22
Williams, G W, rural.....	9537-F3	Wright, Millow, res, 512 W 8th.....	667-J
Williams, J B, res, 321 E 8th.....	757-J	Wright, Pauline, res, 316 W 9th.....	969-J
Williams, Dr J Clay, 1st State Bank Bl.....	525	Wright, W C, res, 712 E 4th.....	328-W

UNDERTAKING

Stubblefield & Sullivan
AMBULANCE
Day & Night PHONE 847
Residence PHONE 544-J

Williams, Dr J Clay, res, 246 W 7th.....	28	Wyatt, Ed, rural NW of City.....	9519-F3
Williams, J E, Grocery, 319 E 10th.....	619	Wyatt, Milly B, res, 313 E 6th.....	162
WILLIAMSPORT WIRE ROPE CO	560		
Wilmoth, G L, res, 214 E 4th.....	142-W		
Wilson, C H, res, 326 W 7th.....	448		
Wilson, Chas C, res, East Hickory.....	379-J		
Wilson, G F, res, 236 W 7th.....	94		
Wilson, Henry, res, 240 W 3rd.....	158-W		
Wilson, John, res, 525 W 6th.....	972-W		
Wilson, J S, res, East 2nd.....	455-J		
Wilson, J T, rural.....	9529-F12		
Wilson, L D, res, 3rd and Maple.....	593		
Wilson, Virgil, res, 521 E 5th.....	247		
Wilson, W D, res, 319 W 7th.....	139-J		
Wilson, W F, res, 709 S Poplar.....	578-J		
Winters, Frank, res, 227 W 12th.....	294-J		
Wiseman, E C, rural.....	9521-F21		

Y

Yakish, Ed, res, 501 W 9th.....	587-W
Yakish, R W, res, 412 E 5th.....	473
Yates, Fred L, res, 310 E 5th.....	25
Young Hotel 172 E 8th.....	43
Young, Ben, res, 302 E 6th.....	268-
Young, Ross O, res, 201 W 9th.....	10

Z

Zackie, Dave, res, 208 W 5th.....	648-
-----------------------------------	------

SUNBEAM GROCERY & TEL. 885
SANITARY MARKET TEL. 681

HOME OF RICHELIEU AND SUNBEAM PURE FOOD PRODUCTS

EVERGREEN FARMS

Owned and Operated by

C. L. Freeland
BRISTOW, OKLA

THE FIRST NATIONAL BANK OF BRISTOW

Pasteurized Milk
and
Cream
Special Baby Milk



Creamery Butter
Cottage Cheese
Buttermilk

PHONE 683

Most Modern and Scientific Dairy Farm in
Creek County. We invite inspection by the
Public at any time. Give us a trial and see
what a difference there is in

EVERGREEN FARMS PRODUCTS

Sample Rooms

Modern, Fireproof

ROLAND HOTEL

Coffee Shop and
Dining Room

"Voice of Oklahoma"
Radio Station

J. E. GOODAN, Proprietor

BRISTOW, OKLAHOMA

AS NEAR TO YOU AS YOUR TELEPHONE

BRISTOW GASOLINE AND SUPPLY CO.

WHOLESALE AND RETAIL

Gasoline, Oils, Automobile Accessories
Tires and Tubes

**Service Stations and Warehouses
In Six Cities**

PHONES - 92 - 942 - 795



Your Telephone

is the Door to your Business.
Supply your Customers the
Key through

Telephone Directory Advertising

They will call again and
again, and each call means
orders for you.

*Call the local manager for rates
and details.*

SOUTHWESTERN BELL TELEPHONE CO.

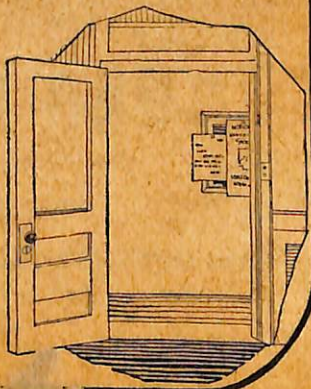

AS NEAR TO YOU AS YOUR TELEPHONE

BRISTOW GASOLINE AND SUPPLY CO.

WHOLESALE AND RETAIL

Gasoline, Oils, Automobile Accessories
Tires and Tubes

**Service Stations and Warehouses
In Six Cities**

PHONES - 92 - 942 - 795



Your Telephone

is the Door to your Business.
Supply your Customers the
Key through

Telephone Directory Advertising

They will call again and
again, and each call means
orders for you.

*Call the local manager for rates
and details.*

SOUTHWESTERN BELL TELEPHONE CO.

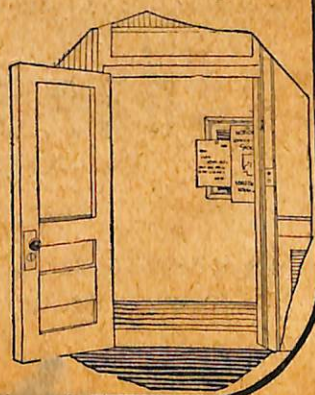

PHONE 689 **Northwestern Grocery & Market** PHONE 689
We Deliver Free 244 West Eighth St. We Deliver Free

WE ARE NOT DOWN TOWN
WE DO NOT PAY HIGH RENT
WE LET OUR CUSTOMERS GET THE DIFFERENCE
WE DELIVER ANY TIME OF THE DAY TO ANY
PLACE IN THE STATE

ETHERICAL STUDIOS, Inc.

— AND —

ETHERICAL RADIO CO.

Broadcasting Station K F R U

"THE WORLDS FINEST RADIO"

NOVELTIES

CADET AND RADIO HOSIERY

CORA MORRISON & CO.

MILLINERY, LADIES READY-TO-WEAR

114 WEST SIXTH AVENUE

Our millinery department is first class. We employ
none but experienced designers and makers.

PHONE 841

QUALITY AND SERVICE

Ready Reference List

Increase your Telephone
..Orders..

by placing your adv. here

Listings in the Ready Reference List May Be Arranged for at Standard Rates
By Application to the Manager's Office.

Attorneys

Cheatam & Beaver, Groom Bl	55
Hicks & Burks, Amer Natl Bk Bl	857
Johnson (F M) & Miller, Over Abrahams	29
Laux & Loeffler, Groom Bl	420
Pounders & Pardoe, 207 Groom Bl	459
Smith, L L, 7 1st Natl Bank Bl	494

Auto Livery

Fisk Taxi Line, 6th and Main	500
Roland Livery, Roland Hotel	102

Auto Sales and Garages

Central Garage, 115 W 7th	64
---------------------------	----

Auto Sales & Service

Ford Service, 10th and Main	275
-----------------------------	-----

Auto Tire Shop

Bristow Tire Shop, 215 S Main	187
Phil-Monte Service Co, 2nd and Main	852

Banks

First National Bank, 7th and Main	8
-----------------------------------	---

Battery Service Stations

BATES (TOM) BATTERY CO.	
214 S Main	778
Bristow Battery Station, 122 E 6th	443

Beauty Parlors

Advance Beauty Shop, Groom Bl	780
Marcelle Beauty Shoppe, 207 N Main	400
Marinello Beauty Shop, 1st State Bk Bl	103

Billiard Halls

Brunswick Billiard Parlor, 102 S Main	983
Smoke House Club, E 7th	745
Stag Club, 117 S Main	743
The Club Smoke Shop, 121 N Main	46

Blacksmiths and Horseshoers

Griffis, James T, 106 W 4th	576
-----------------------------	-----

Boiler Works

Conway Bros Boiler & Welding Works, 1st	746
Modern Boiler Works, 121 E 2nd	70

Bristow Public Schools

High School, West 10th	207
Junior High School, West 10th	442
Washington School, 1st and Hickory	22

Cafes

Busy Bee Cafe, East 7th	732
-------------------------	-----

Casing Crews

Williams (Bob) Casing Crew, 132 W 4th	892
---------------------------------------	-----

Cleaning and Pressing

French Cleaning & Tailoring, Postoffice Bl	760
Ideal Cleaning Works, 424 S Main	733
Model Cleaners, 130 E 5th	751
No Delay Cleaners, 111 W 6th	310
Nobby Cleaners, 311 N Main	118
Parisian Cleaners, 107 E 7th	131

Clothing Stores

Clarke Brothers, South Main	66
-----------------------------	----

Dairies

Giles, Ed, Bristow Dairy, 143 W 10th	748
--------------------------------------	-----

Dentists

Conger, Dr R W, 103 S Main	172
Ralls, Dr R L, 6th and Main	611
Schrader, Dr L B, 211½ N Main	808

Department Stores

Katz Department Store, Groom Bl	431
---------------------------------	-----

Drug Stores

Anderson & Gilliland, 7th and Main	813
Anderson & Gilliland, 7th and Main	855
Bristow Drug Company, 219 N Main	91
Bristow Variety Store, South Main	45
Palace Drug Company	47
Pioneer Drug Company, 109 N Main	38
Quaker Drug Company, 120 N Main	725

Dry Goods

Boston Store, 213 N Main	93
Shamas Dry Good Co, 204 N Main	553

Feed Stores

Banner Feed Company, 205 E 5th	622
Henson, B, Feed Store, 111 E 7th	305
Oil City Feed Store, 504 E 2nd	638

Filling Stations

Bristow Gasoline & Supply Co, 10th & Main	92
Constantine Oil Corp, 5th and Main	353
Freeland Gasoline Station, 1st and Main	795
Live Oak Gasoline Co, 4th and Main	566
Oak Street Filling Station, 1st and Oak	358-W
PHIL-MONT SERVICE CO. , 2nd & Main	852

Furniture and Hardware

Ford Hardware Co, 209 N Main	62
Grimes & Co, Furn & Hdw, 208 N Main	319
Stone (A H) Hardware Co, 6th & Main	18

Gas and Electric Companies

Okla Gas & Elec Co, West 7th	630
------------------------------	-----

General Merchandise

Bogle, J M, North Main	2
Bowman, L E, 113 E 5th	40
Jackson, J M, 214 N Main	13
Wolfe Mercantile Co, South Main	36

Grocery and Meat Markets

Bishop & Bishop Co, 1st & Chestnut	609-W
Central Meat Market, North Main	35
City Meat Market, 116 S Main	370
Gawey, Sam, Grocery, S Main	82
Northwestern Grocery, 244 W 8th	689
Purity Market & Grocery, North Main	700
Self Service & Market, Roland Hotel Bl	60
Spencer, C A, North Main	701
Symonds Co, 412 S Elm	573

Hotels and Rooming Houses

American Hotel, 112½ East 7th	1022
Bristow Hotel, 7th and Main	50
Hotel Antlers, 108½ South Main	1033
Hotel Benton, 217½ S Main	1028
Ideal Hotel, 118½ South Main	839
Modern Hotel, 219½ North Main	1027

Insurance

Combs, Alba, Agency, Groom Bl	270
Rebstein, Tom D, Agency, West 6th	528
Rivers, J B, Real Estate & Insurance, 120 South Main	858

Laundries

Bristow Laundry, W 6th	337
Family Wet Wash Laundry, Walnut and Lincoln	744

Lumber Companies

Fullerton Stuart Lumber Company, S Main	604
Okmulgee Lumber Co, 3rd & Chestnut	479
Pickering Lumber Co, 133 E 7th	226
Rogers Lumber Co, 116 W 7th	33

Millinery Stores

Watson, Fannie, Millinery, 2 N Main	209
-------------------------------------	-----

Oil Companies

Pierce Petroleum Corporation, East 5th	504
Transcontinental Oil Co, 214 E 9th	236
Transcontinental Oil Co, E of City	9511-F2
Transcontinental Oil Co, E of City	9511-F4
Wilcox, H F, 219 E 9th	311

Oil Well Supply Companies

Cushing, Tim, 205 E 8th	410
Frick Reid Supply Co, 134 E 9th	556
Hinderliter Tool Co, 134 E 7th	322
National Supply Co, East 6th	641
Oil City Tool Co, 125 E 6th	502
Oil Well Supply, E 6th	671
Parkersburg Rig & Reel Co, 142 E 11th	545

Producers Supply & Tool Co, 135 E 5th	63
Republic Supply Co, East 6th	166

Packing House Companies

Bristow Packing House	602
-----------------------	-----

Pipe Lines

Prairie Pipe Line Co, Groom Bl	407
--------------------------------	-----

Planing Mills

Griffis, James T, Lincoln & Walnut	576
------------------------------------	-----

Physicians and Surgeons

Boyd, Dr F M, 12 1st State Bank Bl	565
Coppedge, Dr O C, Over Abrahams Store	78
Gillespie, Dr C M, Office	525
King, Dr E W, Watson Bl	104
Reynolds, Dr E W, Office, 1st State Bk Bl	48
Sisler & Sisler, Drs, 7th and Main	900

Plumbing Supplies

Colaw, A L, Plumber, North Main	74
---------------------------------	----

Printing Companies

Commercial Printing Co, 120 E 7th	616
-----------------------------------	-----

Public Stenos. and Notary Publics

Stockton, Dr J W, 106 East 6th	338
--------------------------------	-----

Real Estate

Purdy, A H & Son, 119 N Main	24
Rebstein, Tom D, Agency, 107 W 6th	528

Studios

City Studio, The, 215½ N Main	739
Hallpike Studio, Stone Bl	249

Supply Companies

Bovaird Supply Co, 1st and Main	779
International Supply Co (Successors to Okla Tool & Supply Co) East 9th	178
Marion Machine, Foundry & Supply Co, South Main	840

Tank Companies

Producers Tank Co, 404 W 9th	687
------------------------------	-----

Teaming Contractors

Jones, L C, 213 E 9th	763-W
McCutcheon, Alex, Chestnut & Jackson	609-J

Transfer & Baggage

S & S Transfer Co, East 7th	1004
Senter's Transfer, 143 W 7th	189

Truck Contractors

France, J W, 136 W 5th	124-J
------------------------	-------

Welding Shops

Lucas Welding Shop, 125 East 5th	506
----------------------------------	-----

Furniture and Hardware

Ford Hardware Co, 209 N Main.....	62
Grimes & Co, Furn & Hdw, 208 N Main.....	319
Stone (A H) Hardware Co, 6th & Main.....	18

Gas and Electric Companies

Okla Gas & Elec Co, West 7th.....	630
-----------------------------------	-----

General Merchandise

Bogle, J M, North Main.....	2
Bowman, L E, 113 E 5th.....	40
Jackson, J M, 214 N Main.....	13
Wolfe Mercantile Co, South Main.....	36

Grocery and Meat Markets

Bishop & Bishop Co, 1st & Chestnut.....	609-W
Central Meat Market, North Main.....	35
City Meat Market, 116 S Main.....	370
Gawey, Sam, Grocery, S Main.....	82
Northwestern Grocery, 244 W 8th.....	689
Purity Market & Grocery, North Main.....	700
Self Service & Market, Roland Hotel Bl.....	60
Spencer, C A, North Main.....	701
Symonds Co, 412 S Elm.....	573

Hotels and Rooming Houses

American Hotel, 112½ East 7th.....	1022
Bristow Hotel, 7th and Main.....	50
Hotel Antlers, 108½ South Main.....	1033
Hotel Benton, 217½ S Main.....	1028
Ideal Hotel, 118½ South Main.....	839
Modern Hotel, 219½ North Main.....	1027

Insurance

Combs, Alba, Agency, Groom Bl.....	270
Rebstein, Tom D, Agency, West 6th.....	528
Rivers, J B, Real Estate & Insurance, 120 South Main.....	858

Laundries

Bristow Laundry, W 6th.....	337
Family Wet Wash Laundry, Walnut and Lincoln.....	744

Lumber Companies

Fullerton Stuart Lumber Company, S Main.....	604
Okmulgee Lumber Co, 3rd & Chestnut.....	479
Pickering Lumber Co, 133 E 7th.....	226
Rogers Lumber Co, 116 W 7th.....	33

Millinery Stores

Watson, Fannie, Millinery, 2 N Main.....	209
--	-----

Oil Companies

Pierce Petroleum Corporation, East 5th.....	504
Transcontinental Oil Co, 214 E 9th.....	236
Transcontinental Oil Co, E of City.....	9511-F2
Transcontinental Oil Co, E of City.....	9511-F4
Wilcox, H F, 219 E 9th.....	311

Oil Well Supply Companies

Cushing, Tim, 205 E 8th.....	410
Frick Reid Supply Co, 134 E 9th.....	556
Hinderliter Tool Co, 134 E 7th.....	322
National Supply Co, East 6th.....	641
Oil City Tool Co, 125 E 6th.....	502
Oil Well Supply, E 6th.....	671
Parkersburg Rig & Reel Co, 142 E 11th.....	545

Producers Supply & Tool Co, 135 E 5th.....	63
Republic Supply Co, East 6th.....	166

Packing House Companies

Bristow Packing House.....	602
----------------------------	-----

Pipe Lines

Prairie Pipe Line Co, Groom Bl.....	407
-------------------------------------	-----

Planing Mills

Griffis, James T, Lincoln & Walnut.....	576
---	-----

Physicians and Surgeons

Boyd, Dr F M, 12 1st State Bank Bl.....	565
Coppedge, Dr O C, Over Abrahams Store.....	78
Gillespie, Dr C M, Office.....	525
King, Dr E W, Watson Bl.....	104
Reynolds, Dr E W, Office, 1st State Bk Bl.....	48
Sisler & Sisler, Drs, 7th and Main.....	900

Plumbing Supplies

Colaw, A L, Plumber, North Main.....	74
--------------------------------------	----

Printing Companies

Commercial Printing Co, 120 E 7th.....	616
--	-----

Public Stenos. and Notary Publics

Stockton, Dr J W, 106 East 6th.....	338
-------------------------------------	-----

Real Estate

Purdy, A H & Son, 119 N Main.....	24
Rebstein, Tom D, Agency, 107 W 6th.....	528

Studios

City Studio, The, 215½ N Main.....	739
Hallpike Studio, Stone Bl.....	249

Supply Companies

Bovaird Supply Co, 1st and Main.....	779
International Supply Co (Successors to Okla Tool & Supply Co) East 9th.....	178
Marion Machine, Foundry & Supply Co, South Main.....	840

Tank Companies

Producers Tank Co, 404 W 9th.....	687
-----------------------------------	-----

Teaming Contractors

Jones, L C, 213 E 9th.....	763-W
McCutcheon, Alex, Chestnut & Jackson.....	609-J

Transfer & Baggage

S & S Transfer Co, East 7th.....	1004
Senter's Transfer, 143 W 7th.....	189

Truck Contractors

France, J W, 136 W 5th.....	124-J
-----------------------------	-------

Welding Shops

Lucas Welding Shop, 125 East 5th.....	506
---------------------------------------	-----

Bristow Transfer Company

Local and Long Distance
Hauling

STORAGE

118 E. 7th

Phone 120

Winter 1925

Fullerton - Stuart Lumber Co.

Phone 604

**Consult Us Before
Building**

H. P. HOLLEY, Mgr.

RES. PHONE 913-W

Call number 680 for

HEALDS AUTO SUPPLY

**A FULL LINE OF
REPLACEMENT PARTS**

PERSONAL SERVICE

Studebaker

THOMAS MOTOR CO.

SALES AND SERVICE

124 E. 7th

Bristow, Okla.

PHONE 871

Directors
O. D. GROOM E. A. MILLS J. M. VINCENT, JR.
W. W. GROOM DAVID KELLY

CALL "NUMBER 8" FOR

THE FIRST NATIONAL BANK

CAPITAL AND SURPLUS \$70,000.00
RESOURCES A MILLION AND A HALF DOLLARS

Officers
W. W. GROOM, President O. D. GROOM, Cashier

BISHOP & ROACH MOTOR CO.

DODGE BROTHERS
MOTOR CARS

207 E. SEVENTH

PHONE 122

J. B. RIVERS
INSURANCE AGENCY

FIRE
TORNADO
WORKMANS COMPENSATION

AUTOMOBILE
PLATE GLASS
LIFE

THE KIND OF SERVICE THAT IS APPRECIATED
PHONE 858 **221 S. MAIN**